

# USE AND CARE GUIDE

USA Item 1010851068  
Canada Item 1001852754  
Mexico Item 214789  
Model 24SV24648

## 12FT HOVERING WITCH



Questions, problems, missing parts? Before returning to the store, please have a copy of your receipt ready and email the SVI customer experience team (customerservice@svius.com) within 90 days of the date of purchase or call Home Accents Holiday Customer Service 8 a.m. - 7 p.m., EST, Monday - Friday, 9 a.m. - 6 p.m., EST, Saturday

1-855-HD-HOLIDAY (1-855-434-6543)  
HOMEDEPOT.COM

**ASSEMBLY REQUIRES AT LEAST 2 ADULTS, 3 ADULTS ARE RECOMMENDED. PLEASE FOLLOW THE STEP BY STEP GUIDE AND ENJOY YOUR 12FT HOVERING WITCH!**

### IMPORTANT TIPS:

- Ensure that item's adapter is plugged in with the screw cap tightened at the Function Control Box and plugged in the wall.
- Ensure that the switch on the function control box is on the desired setting.
- If not functioning properly (ex: eyes & body don't light up), ensure that cables are connected to their corresponding cable as shown in the instruction sheet.
- Be sure nothing is blocking movement or caught in moving parts.
- Ensure that the floor or surface that the item sits on is flat and level.
- Ensure that the volume is not all the way down.
- Be sure nothing is blocking the sensor. Witch only speaks on SENSOR setting. See Operations Instructions page 5 for complete details.

### PARTS LIST

- A. Right Base Half x 1
- B. Left Base Half x 1
- C. Lower Support Pole x 1
- D. Broom Bristles x 1
- E. Support Pole x 1
- F. Broom Stick Bottom x 1
- G. Broom Stick Middle x 1
- H. Broom Stick Upper x 1
- I. Upper Support Pole x 1
- J. Broom Stick Cap x 1
- K. Right Arm x 1
- L. Right Hand x 1
- M. Costume x 1
- N. Upper Torso Frame and Motor x 1
- O. Lower Torso Frame and Control Box x 1
- P. Head x 1
- Q. Hip Hoop x 1
- R. Leg Frames x 2
- S. Foam Tubes x 2
- T. Left Arm x 1
- U. Left Hand x 1
- V. Cape x 1
- W. Hat x 1
- X. Broomstick Top x 1
- Y. Base Extensions x 4
- Z. Adapter Reciever x 1
- Z1. Elastic Band x 1
- Z2. Stakes x 4
- Z3. Adapter \* x 1

Power Adapter \* Spec  
Input: 120V~60Hz  
Output: 5.9V 2.0A  
Wattage: 11.8W



NOTE: Throughout the instructions, Right and Left are from the character's point of view.

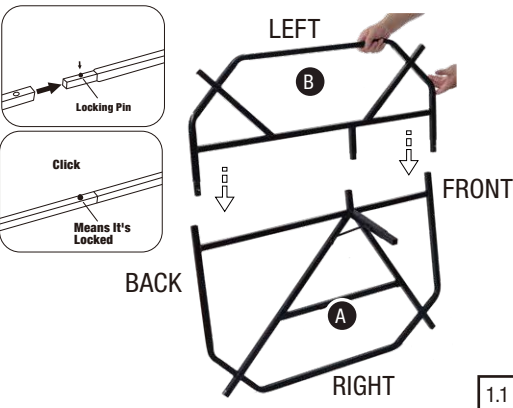

NOTE: Remove wing nut from the (A) Right Base before attaching the (C) Lower Support Pole. Remove clips from the struts of the (C) Lower Support Pole before attaching to the (A) Right Base.

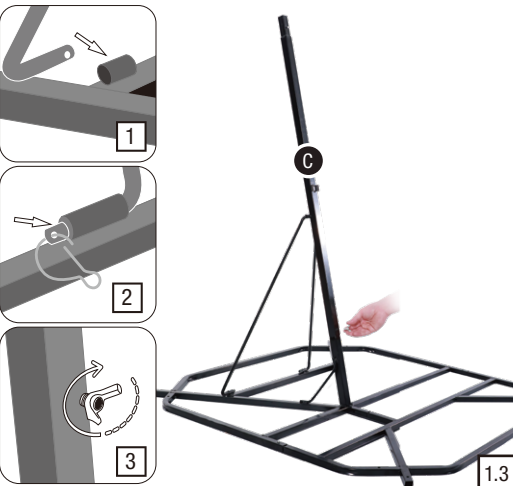
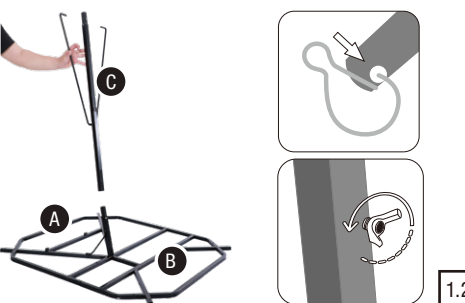

NOTE: Place the block of the (Z) Adapter Receiver in the (D) Broom Bristles with the remaining cable emerging from the top.

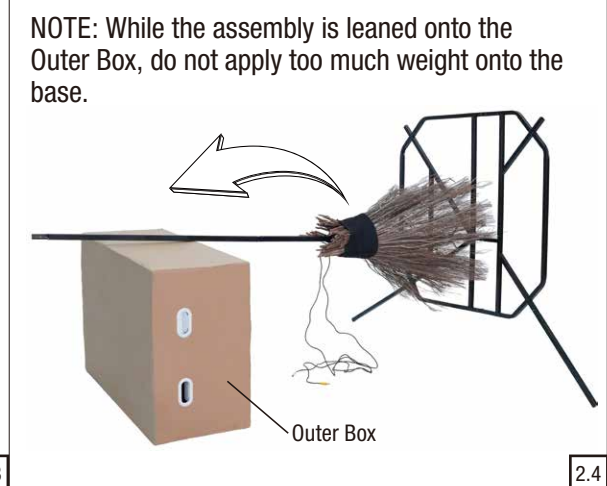
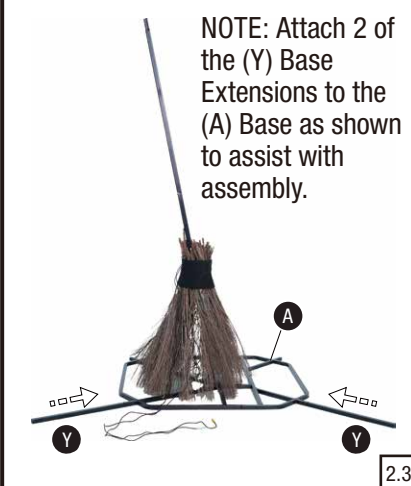
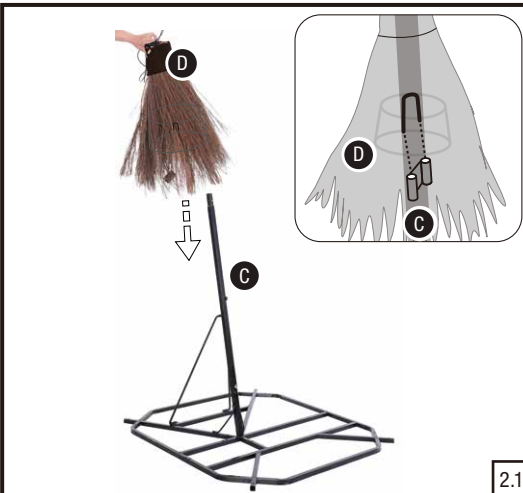
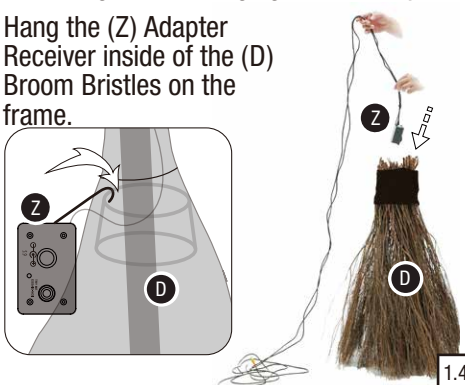



NOTE: Guide the (Z) Adapter Receiver cable through the (D) Broom Bristles and (F) Broom Stick 1 before sliding (F) Broom Stick 1 onto the (E) Support Pole.

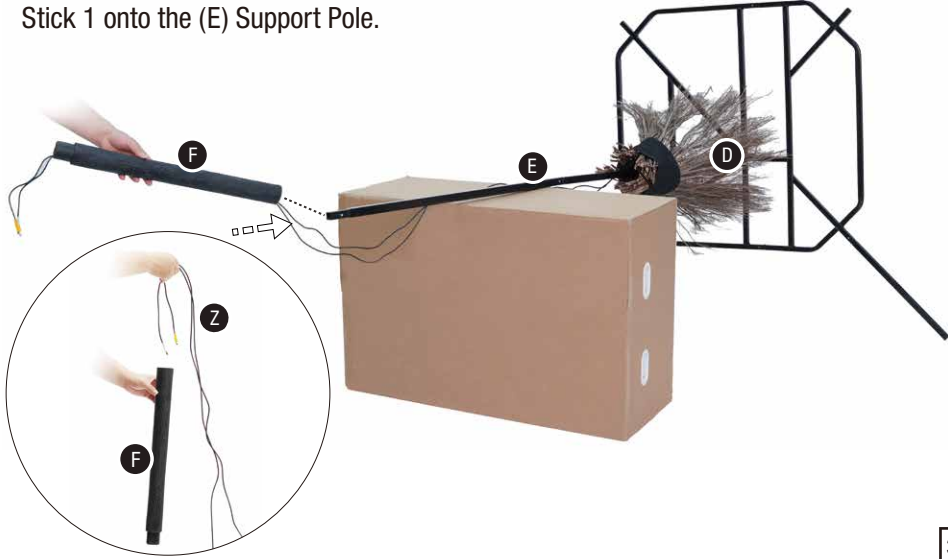

3.1

NOTE: Guide the (Z) Adapter Receiver cable through the (G, H) Broom Sticks before sliding them onto the (E) Support Pole.

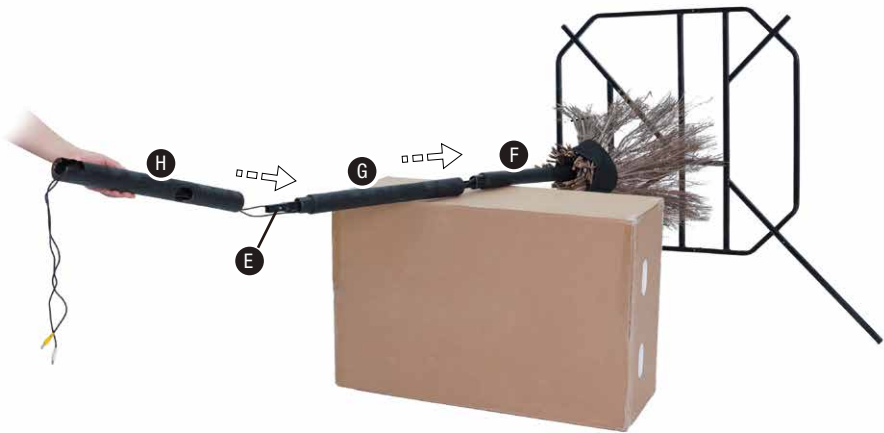

3.2

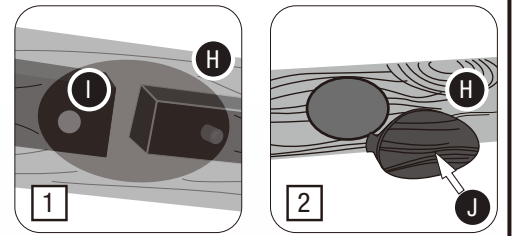

4.1

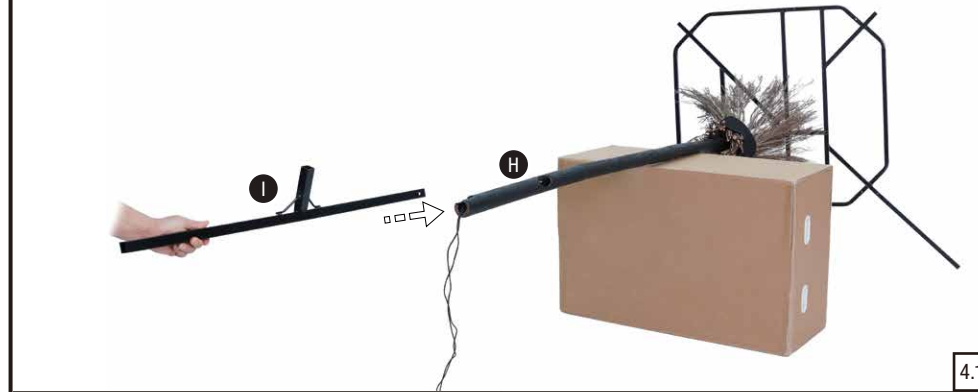

NOTE: Connect the cable from the inside of the (L) Right Hand to the corresponding cable available from the (K) Right Arm.

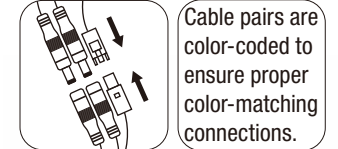

Cable pairs are color-coded to ensure proper color-matching connections.

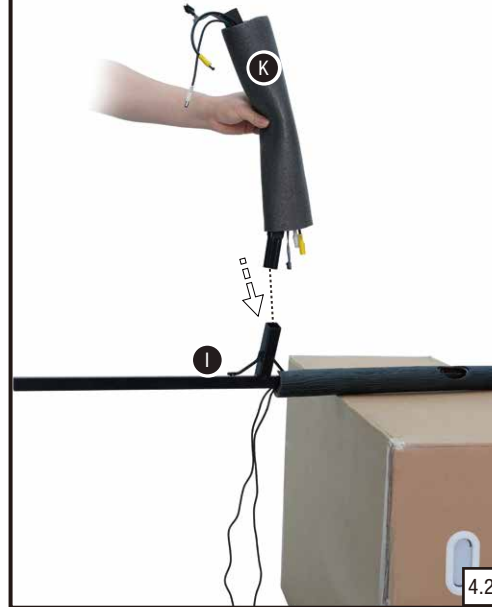

4.2



4.3

NOTE: Slide the right sleeve of the (M) Costume over the (K) Right Arm.



5.1

NOTE: Attach the cables from the (P) Head to the cables available from the (N) Upper Torso with Motor. Attach these through the hole at the top of the (N) Upper Torso with Motor.

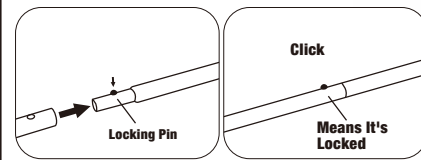

Click  
Means It's Locked

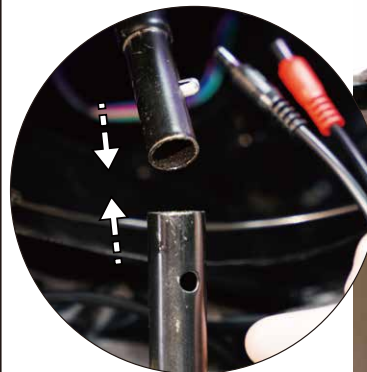

6.1

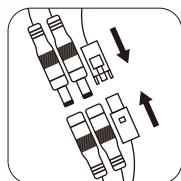

Cable pairs are color-coded to ensure proper color-matching connections.



5.2

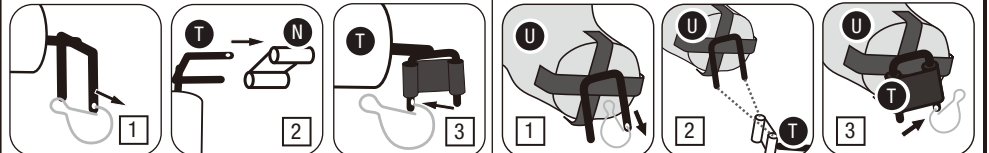

6.2

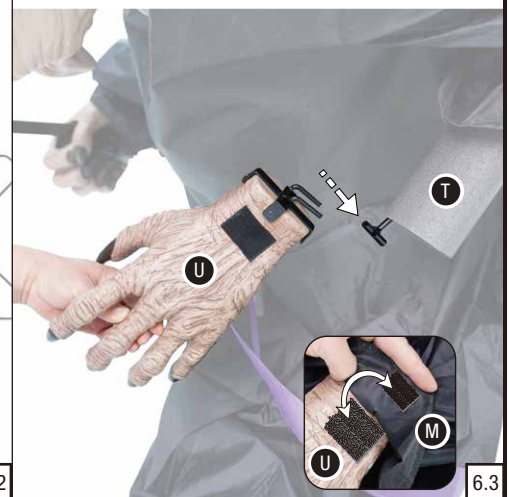

6.3



