

USE AND CARE GUIDE

6 FT ANIMATED STORM TROOPER

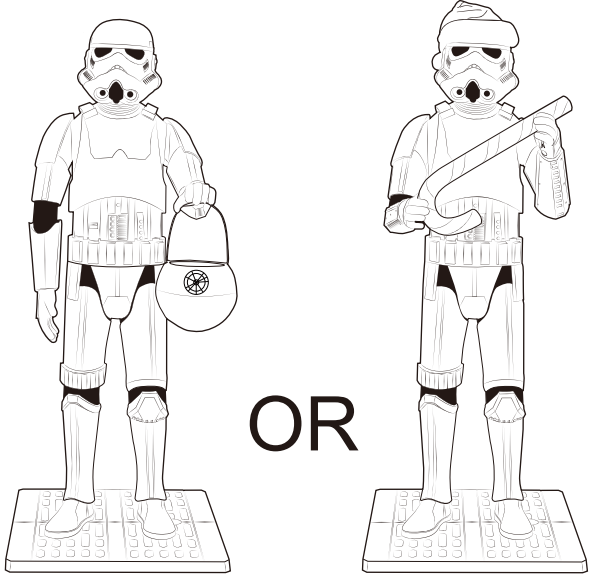

IMPORTANT TIPS:

- Ensure that item's adapter is plugged in at the Function Control Box and plugged in the wall.
- Ensure that the switch on the function control box is on the desired setting.
- If not functioning properly (ex: head doesn't move), ensure that cables are connected to their corresponding cable as shown in the instruction sheet.
- Be sure nothing is blocking movement or caught in moving parts.
- Ensure that the floor or surface that the item sits on is flat and level.
- Ensure that the volume is not all the way down.
- Be sure nothing is blocking the sensor. See Operations Instructions page 4 for complete details.

Questions, problems, missing parts? Before returning to the store, please have a copy of your receipt ready and email the SVI customer experience team (customerservice@svius.com) within 90 days of the date of purchase or call Home Accents Holiday Customer Service 8 a.m. - 7 p.m., EST, Monday - Friday, 9 a.m. - 6 p.m., EST, Saturday
1-855-HD-HOLIDAY (1-855-434-6543)
HOMEDPOT.COM

PARTS LIST

- A. Base Platforms x 2
- B. Base x 1
- C. Left Boot x 1
- D. Right Boot x 1
- E. Left Pole x 1
- F. Right Pole x 1
- G. Left Lower Leg x 1
- H. Right Lower Leg x 1
- I. Left Upper Leg x 1
- J. Right Upper Leg x 1
- K. Body x 1
- L. Left Arm x 1
- M. Right Arm x 1
- N. Head x 1
- O. Cannister x 1
- P. Left Cap x 1
- Q. Right Cap x 1
- R. Left Bar x 1
- S. Right Bar x 1
- T. Candy Bucket x 1
- U. Left Hand x 1
- V. Right Hand x 1
- W. Candy Cane x 1
- X. Hat x 1
- Y. Adapter * x 1

Power Adapter * Spec
Input: 120V~60Hz
Output: 5.9V 2.0A
Wattage: 11.8W



TOOLS REQUIRED



NOTE: Throughout the instructions, Right and Left are relative to the character.

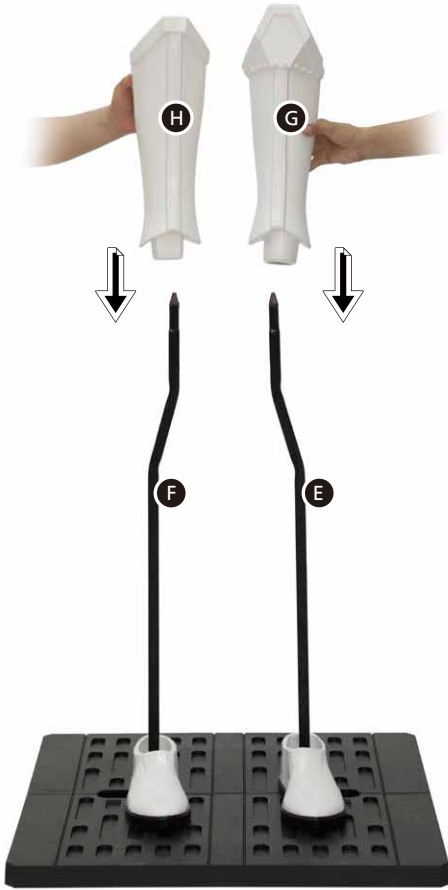
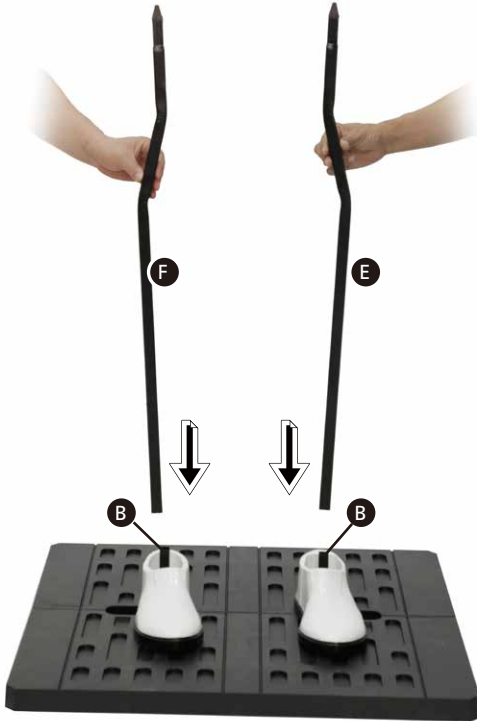
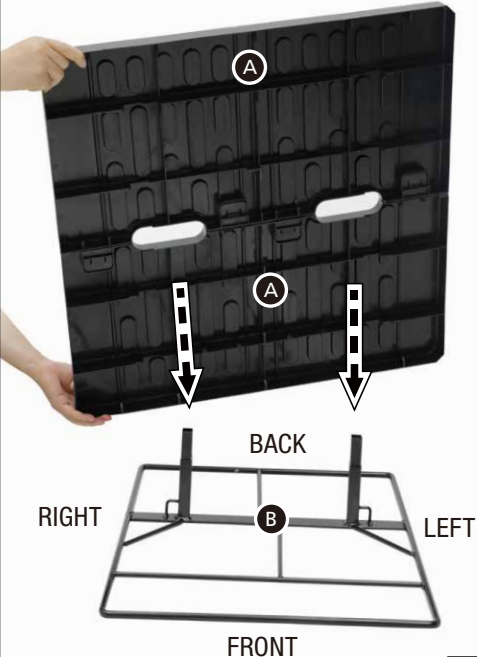
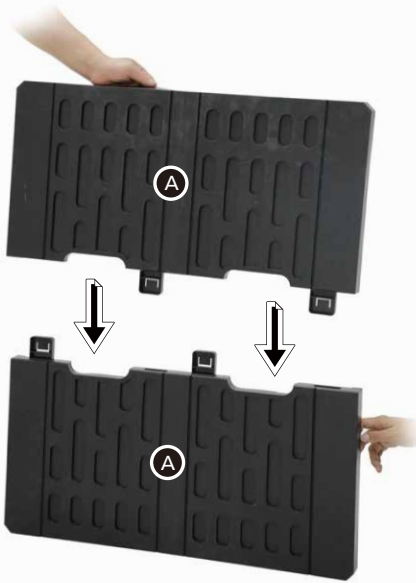
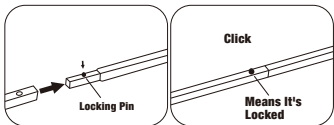

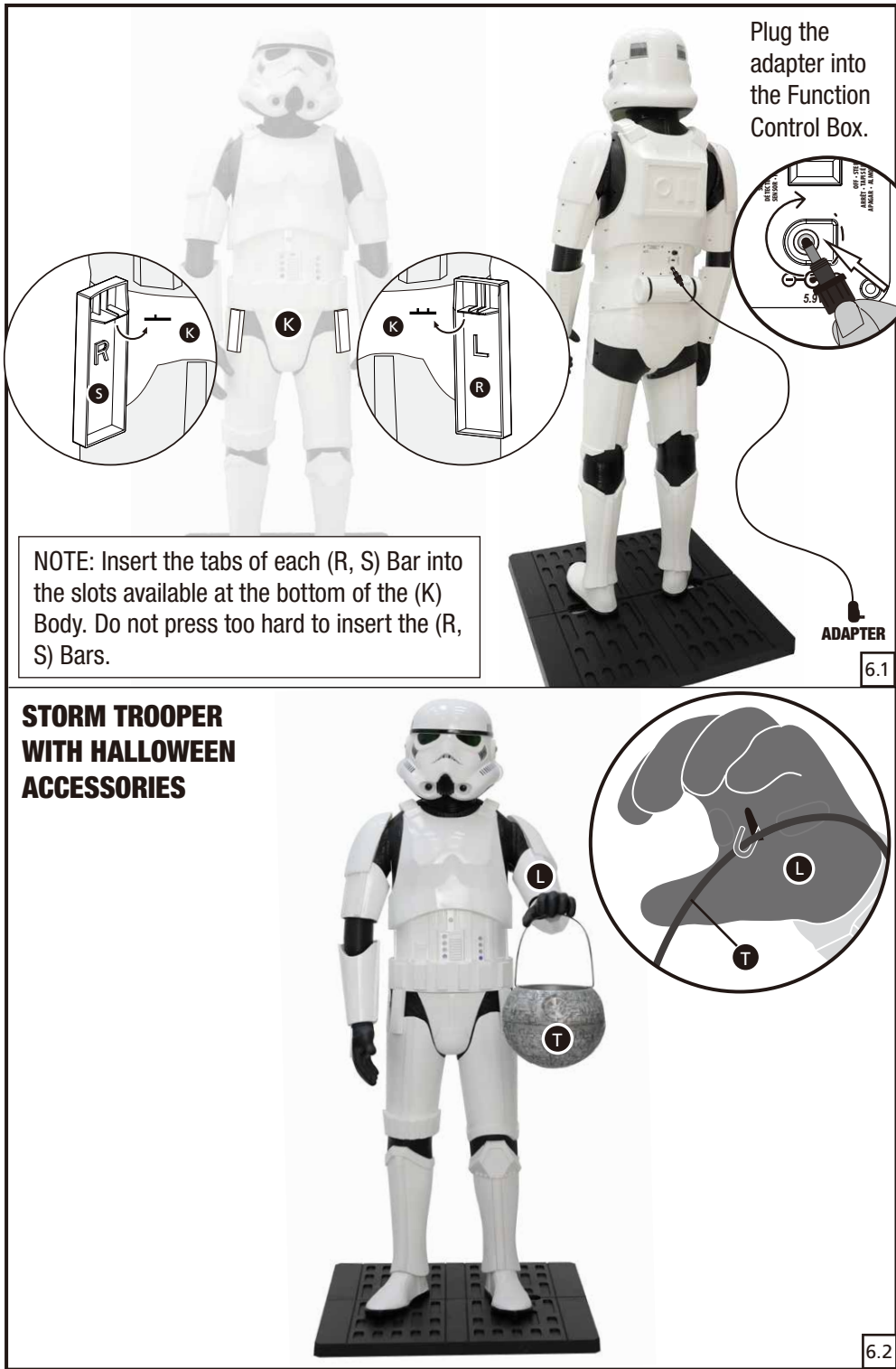
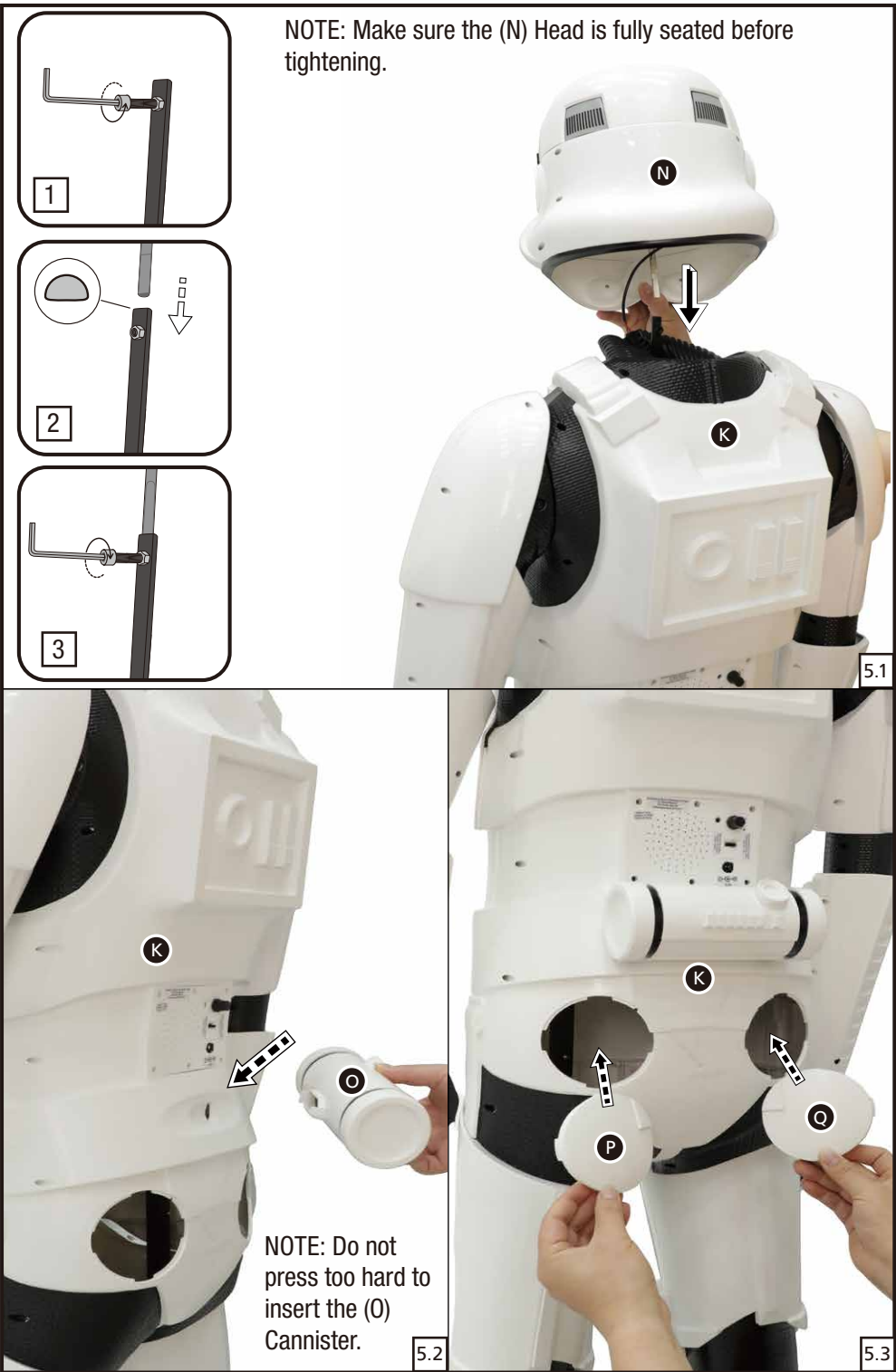
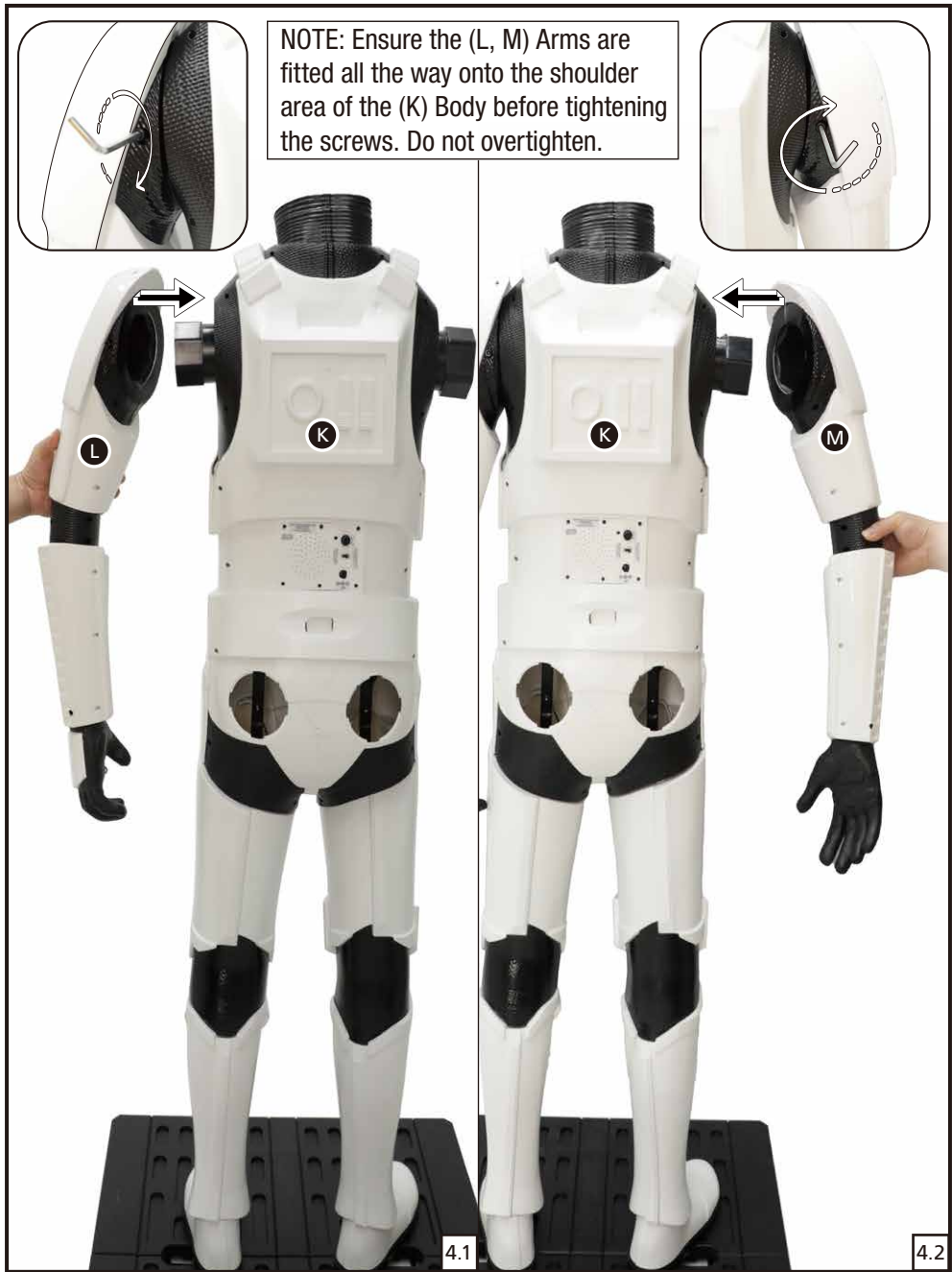
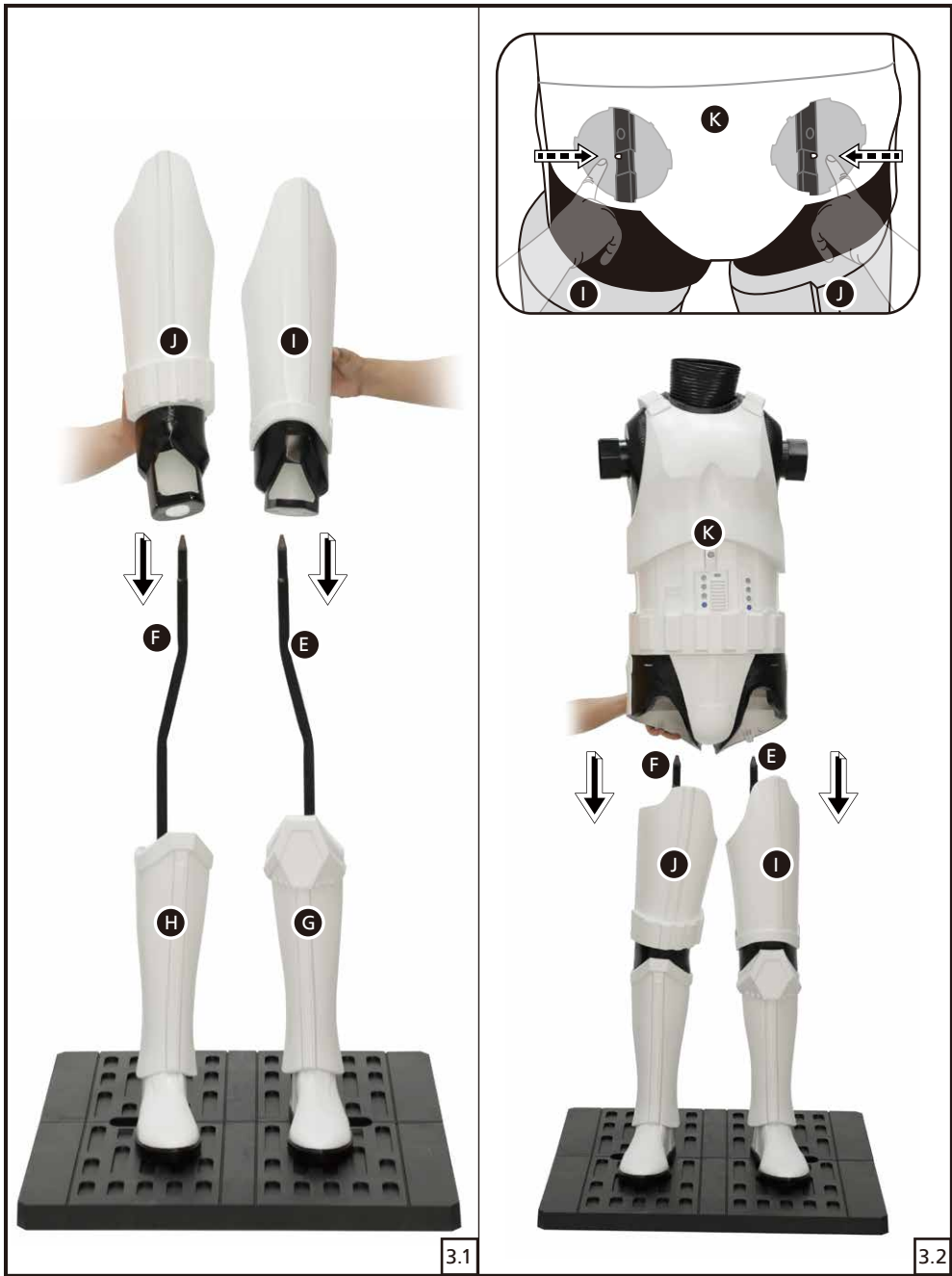

STORM TROOPER WITH CHRISTMAS ACCESSORIES



When setting the Storm Trooper up with Christmas Accessories, the other set of (U, V) Hands needs to replace the set that is already attached to the (L, M) Arms. To remove the hands from the (L, M) Arms, first loosen the hex screws at the wrist area using the Hex Wrench. Once loose, the hands of the (L, M) Arms can be removed by pulling them out of place. Insert the (U) Left Hand into the (L) Left Arm and the (V) Right Hand into the (M) Right Arm and tighten the hex screws using the Hex Wrench. Do not overtighten.

7.1

Position the (W) Candy Cane in the Storm Trooper's (U, V) Hands as shown.



7.2

NOTE: The (X) Hat can be placed on the (N) Head freely or it can be secured in place with the adhesive tabs in the (X) Hat. To attach the (X) Hat with the adhesive tabs, first remove the protective layer from the adhesive tabs and then directly adhere the (X) Hat to the (N) Head.



8.1



IR SENSOR
Be sure nothing is blocking the sensor.

OR



YOUR 6 FT ANIMATED STORM TROOPER IS NOW FULLY ASSEMBLED. PLUG IN AND TURN ON TO LET THE FUN BEGIN!

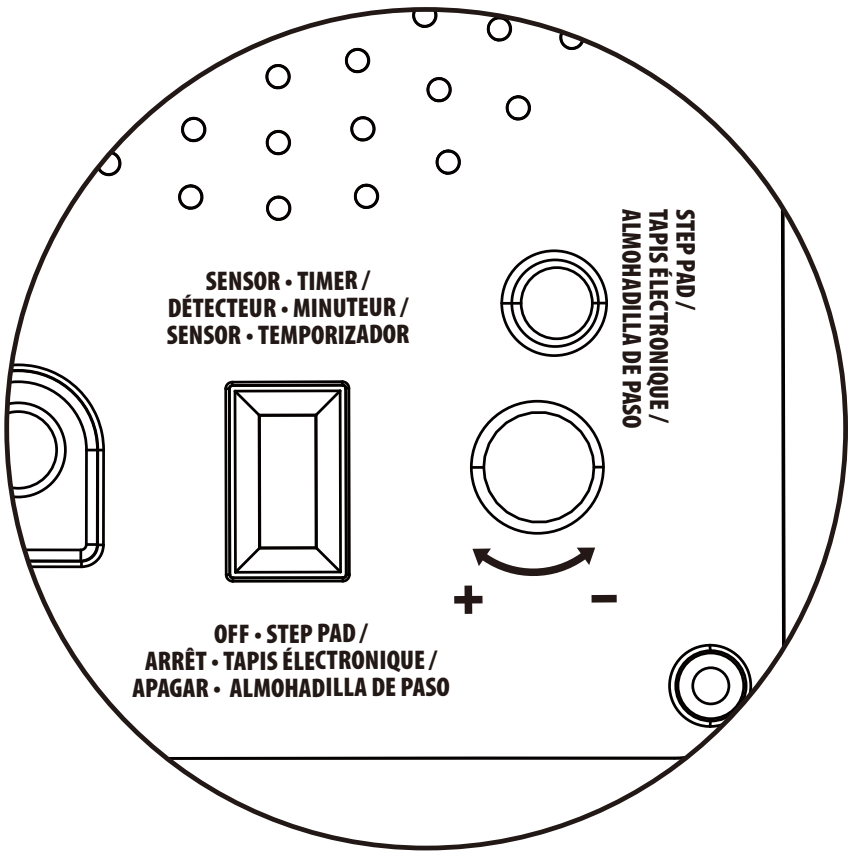
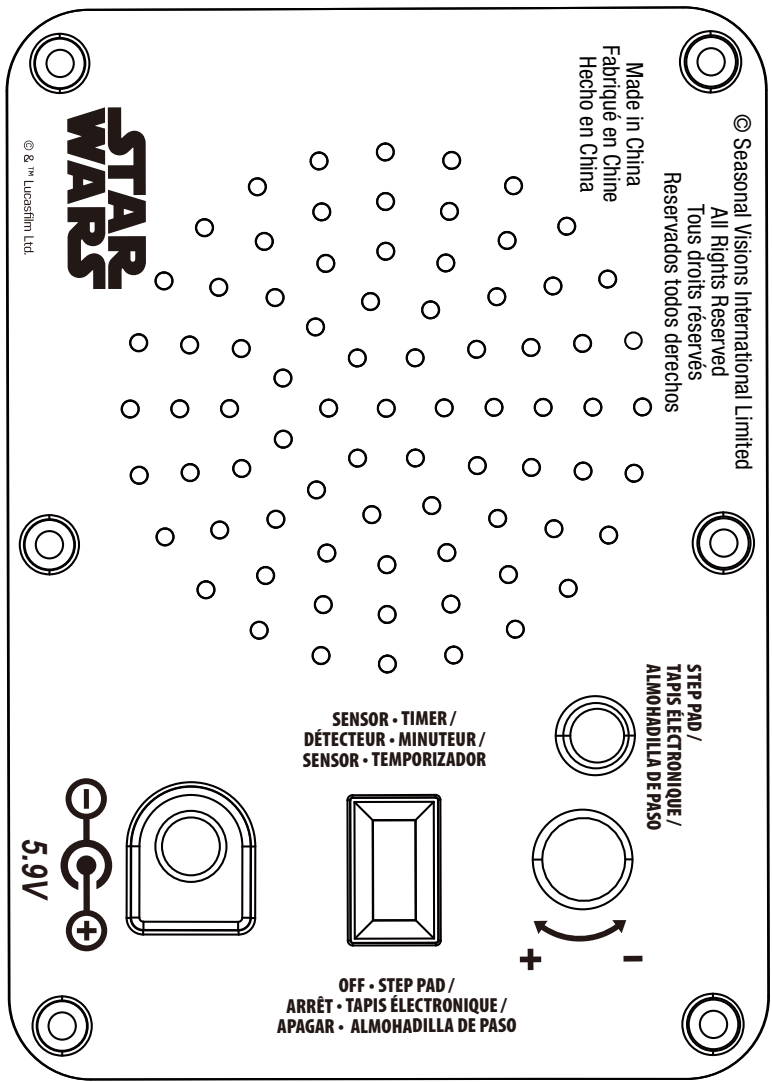

OPERATION INSTRUCTIONS:

1. Plug the power adapter into a standard power outlet and adjust the settings on the Function Control Box, located on the (K) Body, as desired.
2. Settings:

SENSOR • TIMER / DÉTECTEUR • MINUTEUR / SENSOR • TEMPORIZADOR	Toggle the switch to the SENSOR • TIMER position to activate SENSOR • TIMER mode. In this mode, the Sensor can be triggered within a 6 hour period. The 6 hour active period is then followed by an 18 hour inactive period in which the Sensor cannot be triggered. This cycle continues indefinitely until the switch mode is changed. The infra-red (IR) sensor has a range of up to 4 m/13 ft and will activate for 1 activity cycle when someone comes within an 80 degree angle from left to right as well as above and below.
OFF • STEP PAD / ARRÊT • TAPIS ÉLECTRONIQUE / APAGAR • ALMOHADILLA DE PASO	This switch mode allows the item to be activated only if triggered by using a Step Pad or Try Me Button (Not Included). The item will operate for one activity cycle with each Step Pad or Try Me activation. Otherwise, the item will stay off.
	Raise or lower the volume using the volume control turn dial, turn all the way down to turn the volume off .

WARNING:

This item is not a toy and should be used for decoration only. This item contains small parts that can be a choking hazard. Keep all plastic parts away from children.

- Don't climb or pull on product.
- Don't add to or modify product.
- Assemble and place the product on level surfaces only.
- Don't push or tilt product.
- Please assemble item according to instructions.
- Children should be supervised by adults. Item should not be grabbed, as it becomes a tipping hazard.
- Please view all instructions carefully before assembling. Save this instruction sheet for future reference.

CARE AND STORAGE INSTRUCTIONS

When not in use, store this product in its original packing. Keep away from heat and moisture.

This device complies with Part 15 of the FCC Rules. Operation is subject to the following two conditions: (1) This device may not cause harmful interference, and (2) this device must accept any interference received, including interference that may cause undesired operation.

CAUTION: Changes or modifications not expressly approved by the party responsible for compliance could void the user's authority to operate the equipment.

NOTE: This equipment has been tested and found to comply with the limits for a Class B digital device, pursuant to Part 15 of the FCC Rules. These limits are designed to provide reasonable protection against harmful interference in a residential installation. This equipment generates, uses, and can radiate radio frequency energy and, if not installed and used in accordance with the instructions, may cause harmful interference to radio communications. However, there is no guarantee that interference will not occur in a particular installation. If this equipment does cause harmful interference to radio or television reception, which can be determined by turning the equipment off and on, the user is encouraged to try to correct the interference by one or more of the following measures: Reorient or relocate the receiving antenna, Increase the separation between the equipment and receiver. Connect the equipment into an outlet on a circuit different from that to which the receiver is connected. Consult the dealer or experienced radio/TV technician for help.

CAN ICES-003(B)/NMB-003(B)

Questions, problems, missing parts? Before returning to the store, please have a copy of your receipt ready and email the SVI customer experience team (customerservice@svius.com) within 90 days of the date of purchase or call Home Accents Holiday Customer Service 8 a.m. - 7 p.m., EST, Monday - Friday, 9 a.m. - 6 p.m., EST, Saturday
1-855-HD-HOLIDAY
(1-855-434-6543)
HOMEDEPOT.COM

Disney
starwars.com
© & ™ Lucasfilm Ltd.

**STAR
WARS**