

USE AND CARE GUIDE

3.5 FT ANIMATED CHUCKY DOLL



© Universal City Studios LLC. All Rights Reserved.

IMPORTANT TIPS:

- Ensure that the item's adapter is plugged in at the Function Control Box and in the wall.
- Ensure that the prop is on the desired setting.
- If not functioning properly (ex: Arm, mouth, body and eyes don't move), ensure that cables are connected to their corresponding cable as shown in the instruction sheet. Be sure nothing is blocking movement or caught in moving parts.
- Ensure that the floor or surface that the item sits on is flat and level. IF ANY PART IS MISSING OR BROKEN, DO NOT ATTEMPT TO ASSEMBLE THE PRODUCT AND CALL HOME ACCENTS HOLIDAY CUSTOMER SERVICE FROM MON-FRI 8:00AM TO 7:00PM AND SAT 9:00 AM TO 6:00 PM EST AT 1-855-HDHOLIDAY (1-855-434-6543).

Questions, problems, missing parts? Before returning to the store, please have a copy of your receipt ready and email the SVI customer experience team (customerservice@svius.com) within 90 days of the date of purchase or call Home Accents Holiday Customer Service 8 a.m. - 7 p.m., EST, Monday - Friday, 9 a.m. - 6 p.m., EST, Saturday

1-855-HD-HOLIDAY (1-855-434-6543)
HOMEDEPOT.COM

PARTS LIST

- A. Base x 1
- B. Shoes x 2
- C. Legs x 2
- D. Costume x 1
- E. Body with Control Box x 1
- F. Left Arm with Knife x 1
- G. Right Arm x 1
- H. Head x 1
- I. Adapter* x 1

Power Adapter * Specs
 Input: 120V~60Hz
 Output: 5.9V 3A
 Wattage: 17.7W

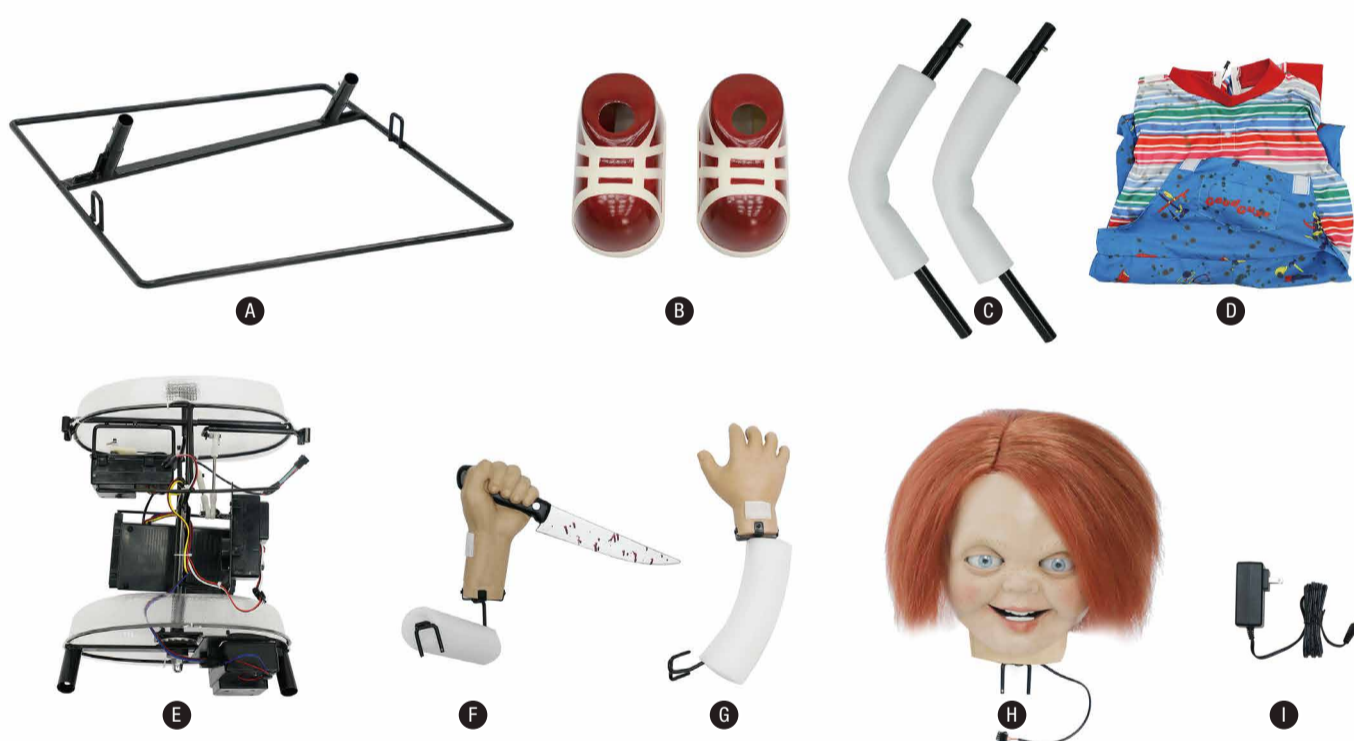

NOTE: Throughout the instructions, Right and Left are from the character's point of view.

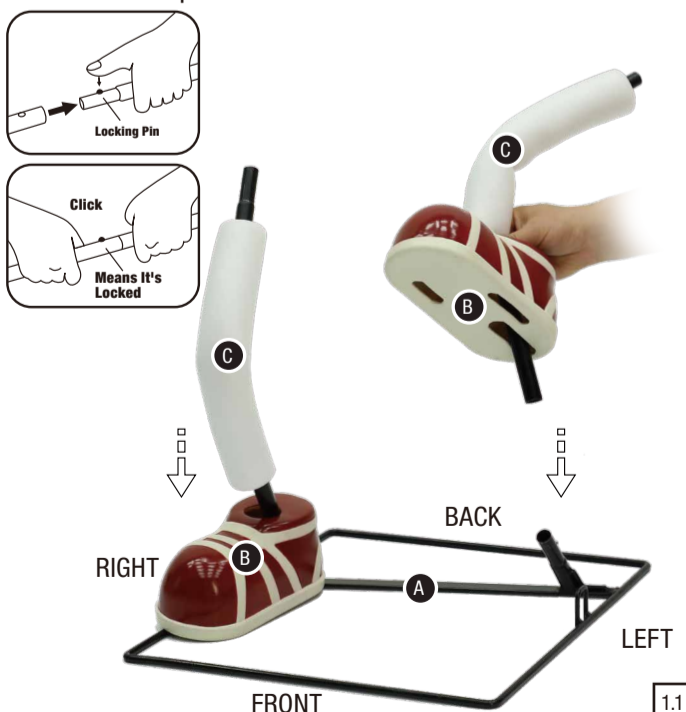

Note: The opening of the (D) Costume at the collar should be facing the back.



Plug the adapter into the Function Control Box.

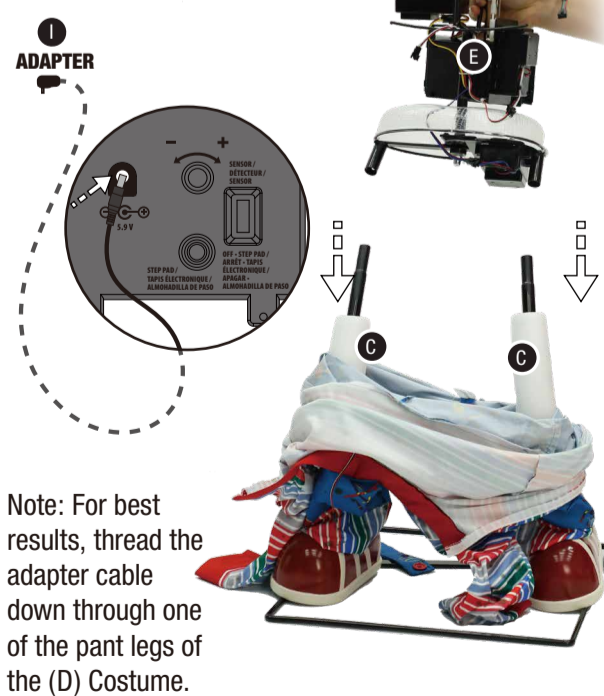

Note: For best results, thread the adapter cable down through one of the pant legs of the (D) Costume.

For each side, slide a (C) Leg through one of the (B) Shoes and connect to the (A) Base using the quick connect push buttons and pre-drilled holes as shown in Figure 1.1. Slide the pant legs of the (D) Costume over the (C) Legs until the (D) Legs emerge from the top as shown in Figure 1.2. Attach the (E) Body with Control Box to the (C) Legs using the quick connect push buttons and pre-drilled holes as shown in Figure 1.3.

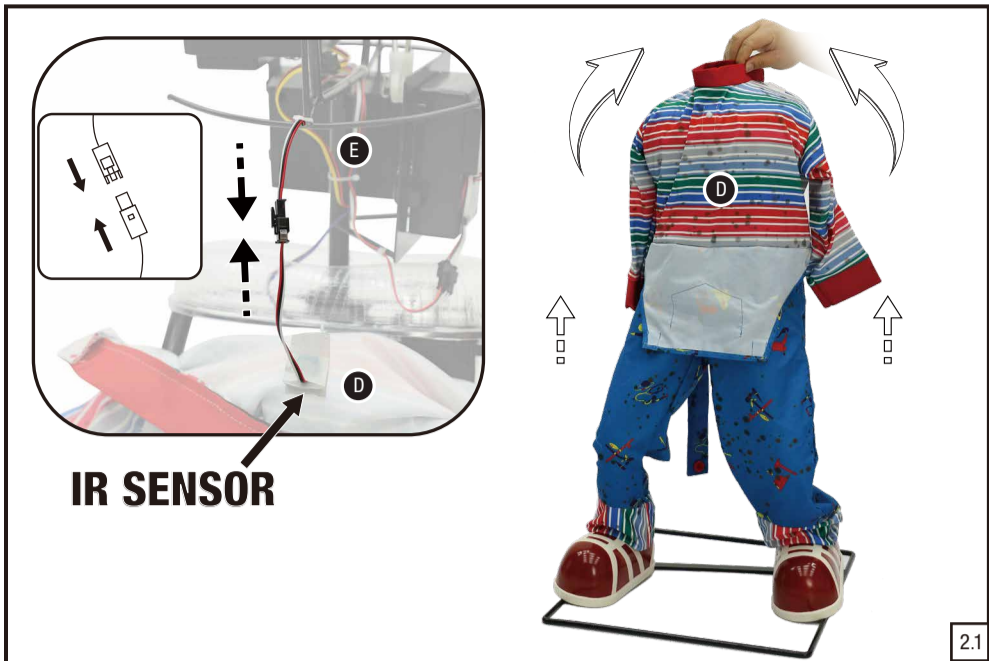

2.1

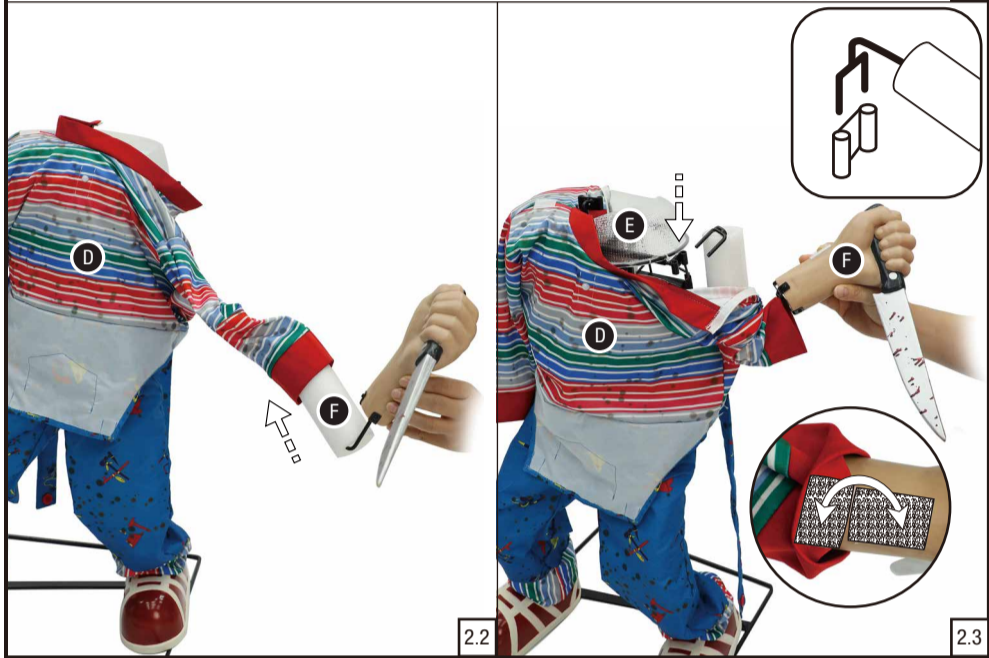

2.2

2.3

Attach the sensor cable from the (D) Costume to the corresponding cable available from the (E) Body with Control Box. Bring the (D) Costume up over the (E) Body with Control Box as shown in Figure 2.1. Slide the forked hook end of the (F) Left Arm with Knife up the left sleeve of the (D) Costume as shown in Figure 2.2. Then set forked hook into the housing at the left side of the (E) Body with Control Box. Attach the sleeve of the (D) Costume to the wrist of the (F) Left Arm with Knife using the hook and loop closure as shown in Figure 2.3.

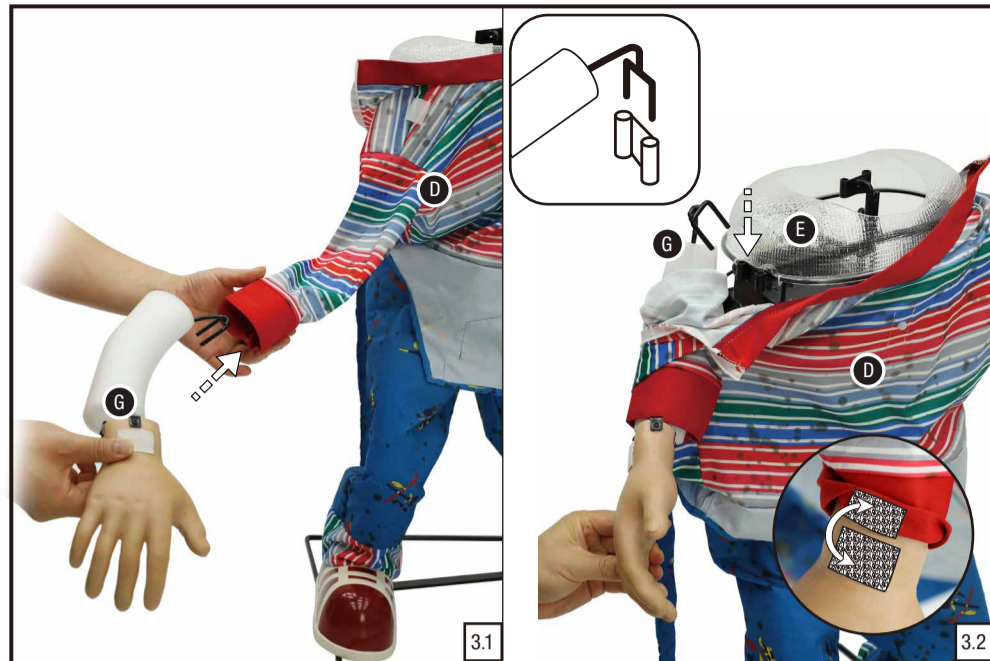

3.1

3.2

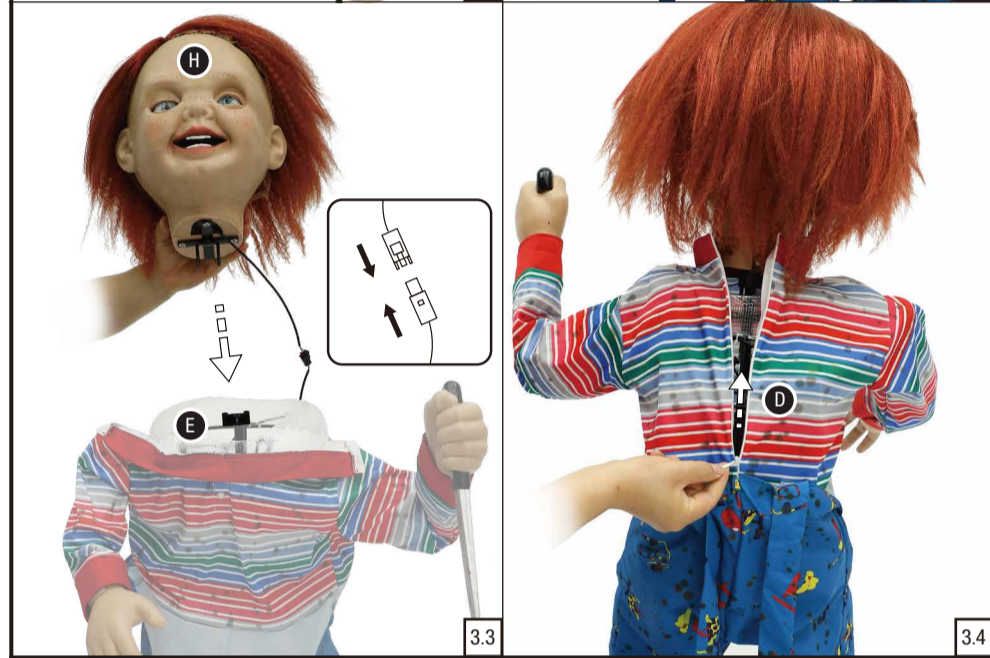

3.3

3.4

Slide the forked hook end of the (G) Right Arm up the right sleeve of the (D) Costume as shown in Figure 3.1. Set the forked hook of the (G) Right Arm into the housing available at the right side of the (E) Body and Control Box. Attach the sleeve of the (D) Costume to the wrist of the (G) Right Arm using the hook and loop closure as shown in Figure 3.2. Attach the cable from the (H) Head to the corresponding cable available from the (E) Body with Control Box. Then slide the forked hook of the (H) Head into the housing available at the top of the (E) Body with Control Box as shown in Figure 3.3. Zip up the back of the (D) Costume as shown in Figure 3.4.



IR SENSOR
Be sure nothing is blocking the sensor.

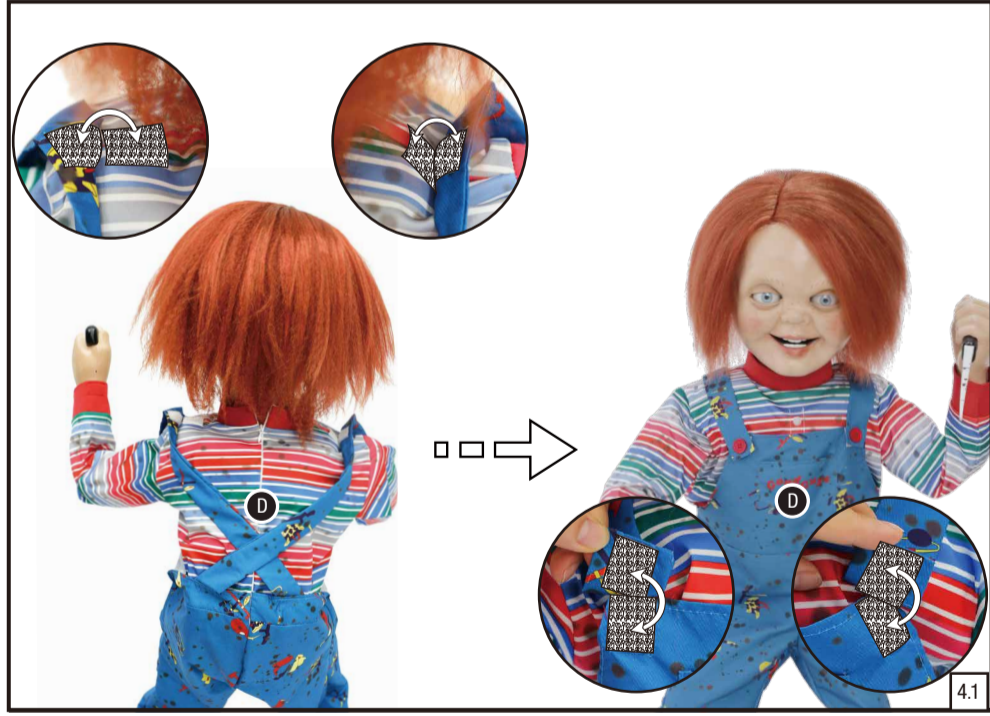

4.1

3.5 FT ANIMATED CHUCKY DOLL IS NOW FULLY ASSEMBLED. PLUG IN AND TURN ON TO LET THE FUN BEGIN!

OPERATION INSTRUCTIONS:

1. Plug the power adapter into a standard power outlet and adjust the settings on the Function Control Box, located on the (E) Body with Control Box, as desired.

2. Settings:

SENSOR / DÉTECTEUR / SENSOR	This switch mode will activate the sound and animation when the Infra red (IR) sensor is activated and will operate for 1 activity cycle with each activation. The Infra red (IR) sensor has a range of up to 4 m/13 ft. and will activate when someone comes within an 80 degree angle from left to right, as well as from above and below.
OFF • STEP PAD / ARRÊT • TAPIS ÉLECTRONIQUE / APAGAR • ALMOHADILLA DE PASO	This switch mode allows the item to be activated only if triggered by using a Step Pad or Try Me Button (Not Included). The item will operate for one activity cycle with each Step Pad or Try Me activation. Otherwise, the item will stay off.
	Raise or lower the volume using the volume control turn dial, turn all the way down to turn the volume off .

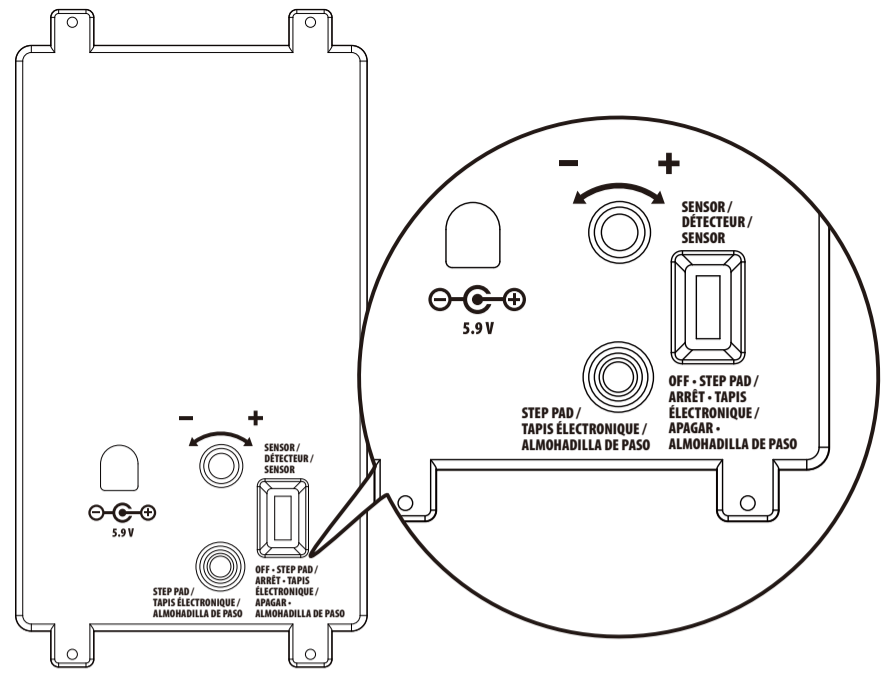

WARNING

This item is not a toy and should be used for decoration only. This item contains small parts that can be a choking hazard. Keep all plastic and wire parts away from children.

1. Please use the adapter supplied by manufacturer.
2. Please assemble item according to instructions. Connect all wires according to matching color.
3. Children should be supervised by adults. Item should not be grabbed, as it becomes a tipping hazard. Keep flammables away from the adapter, as it heats up during operation.

Please view all instructions carefully before assembling. Save this instruction sheet for future reference.

CARE AND STORAGE INSTRUCTIONS

For best performance operate your item indoors. When not in use, store this product in its original packing. Keep away from heat and moisture.

This device complies with Part 15 of the FCC Rules. Operation is subject to the following two conditions: (1) This device may not cause harmful interference, and (2) this device must accept any interference received, including interference that may cause undesired operation.

CAUTION: Changes or modifications not expressly approved by the party responsible for compliance could void the user's authority to operate the equipment.

NOTE: This equipment has been tested and found to comply with the limits for a Class B digital device, pursuant to Part 15 of the FCC Rules. These limits are designed to provide reasonable protection against harmful interference in a residential installation. This equipment generates, uses, and can radiate radio frequency energy and, if not installed and used in accordance with the instructions, may cause harmful interference to radio communications. However, there is no guarantee that interference will not occur in a particular installation. If this equipment does cause harmful interference to radio or television reception, which can be determined by turning the equipment off and on, the user is encouraged to try to correct the interference by one or more of the following measures: Reorient or relocate the receiving antenna, Increase the separation between the equipment and receiver. Connect the equipment into an outlet on a circuit different from that to which the receiver is connected. Consult the dealer or experienced radio/TV technician for help.
CAN ICES-003(B)/NMB-003(B)



© Universal City Studios LLC. All Rights Reserved.

Questions, problems, missing parts? Before returning to the store, Please have a copy of your receipt ready and email the SVI customer experience team (customerservice@svius.com) within 90 days of the date of purchase or call Home Accents Holiday Customer Service 8 a.m. - 7 p.m., EST, Monday - Friday, 9 a.m. - 6 p.m., EST, Saturday

1-855-HD-HOLIDAY (1-855-434-6543)

HOMEDEPOT.COM