

USE AND CARE GUIDE

12 FT. LEVITATING REAPER



Questions, problems, missing parts? Before returning to the store, please have a copy of your receipt ready and email the SVI customer experience team (customerservice@svius.com) within 90 days of the date of purchase or call Home Accents Holiday Customer Service 8 a.m. - 7 p.m., EST, Monday - Friday, 9 a.m. - 6 p.m., EST, Saturday

1-855-HD-HOLIDAY (1-855-434-6543)
HOMEDEPOT.COM

USA Item 1010830999
Canada Item 1001852746
Mexico Item 214757
Model 24SV24287



Video assembly
instructions
available online

ASSEMBLY REQUIRES AT LEAST 2 ADULTS, 3 ADULTS ARE RECOMMENDED. PLEASE FOLLOW THE STEP BY STEP GUIDE AND ENJOY YOUR 12 FT. LEVITATING REAPER!

IMPORTANT TIPS:

- Ensure that item's adapter is plugged in with the screw cap tightened at the Function Control Box and plugged in the wall.
- Ensure that the switch on the function control box is on the desired setting.
- If not functioning properly (ex: head and hands don't light up, head doesn't move), ensure that cables are connected to their corresponding cable as shown in the instruction sheet.
- Be sure nothing is blocking movement or caught in moving parts.
- Ensure that the floor or surface that the item sits on is flat and level.
- Ensure that the volume is not all the way down.
- Be sure nothing is blocking the sensor. Prop only speaks on Sensor Timer Mode or when activated with a Step Pad. See Operations Instructions page 5 for complete details.

PARTS LIST

- A. Right Base Half x 1
 - B. Left Base Half x 1
 - C. Support Pole 1 x 1
 - D. Scythe 1 x 1
 - E. Receiver Box x 1
 - F. Support Pole 2 x 1
 - G. Scythe 2 x 1
 - H. Scythe 3 x 1
 - I. Support Pole 3 x 1
 - J. Left Arm x 1
 - K. Left Hand x 1
 - L. Scythe 4 x 1
 - M. Support Pole 4 x 1
 - N. Costume x 1
 - O. Upper Body Form x 1
 - P. Support Pole 5 x 1
 - Q. Right Arm x 1
 - R. Lower Body Frame with Control Box x 1
 - S. Rib Plate x 1
 - T. Head x 1
 - U. Hood x 1
 - V. Right Hand x 1
 - W. Scythe 5 x 1
 - X. Blade 1 x 1
 - Y. Blade 2 x 1
 - Z. Base Stabilizers x 5
 - Z1. Lower Support Frame x 1
 - Z2. Small Parts Bag x 1
 - Z3. Stakes x 4
 - Z4. Adapter * x 1
- Power Adapter * Spec
Input: 120V~60Hz
Output: 5.9V 3.0A
Wattage: 17.7W



NOTE: Throughout the instructions, Right and Left are from the character's point of view.

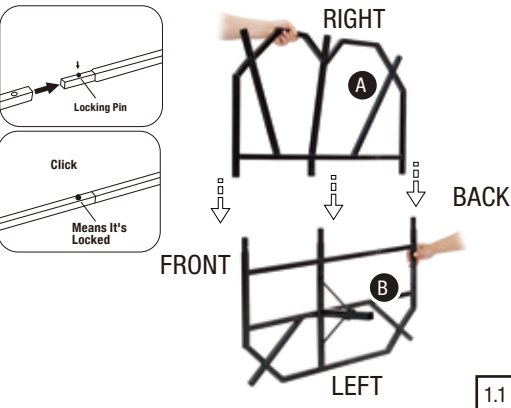

NOTE: Secure the (A) Right Base Half and (B) Left Base Half together by using an M6 screw from the (Z2) Small Parts Bag. Use another M6 screw from the (Z2) Small Parts Bag to secure (C) Support Pole 1 to the (B) Left Base Half.

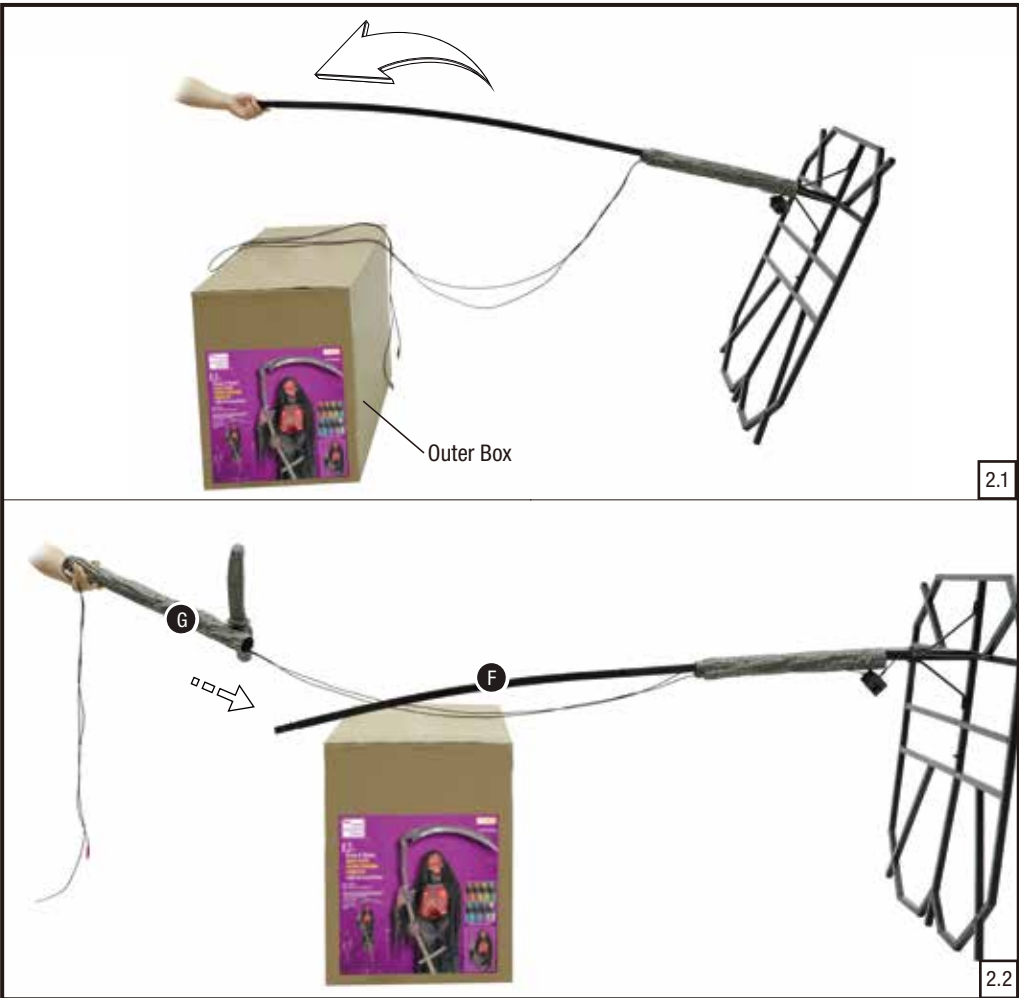
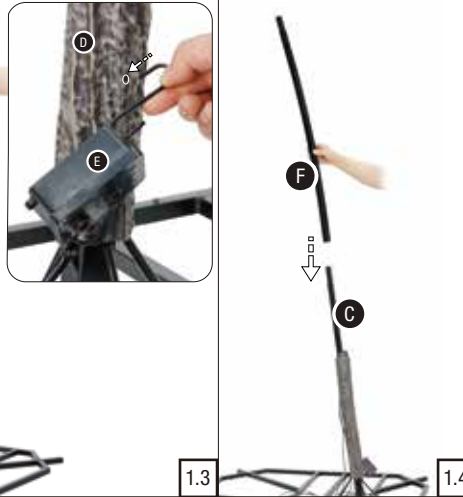
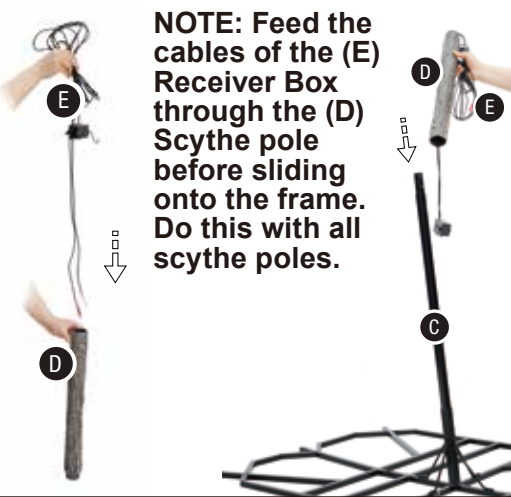
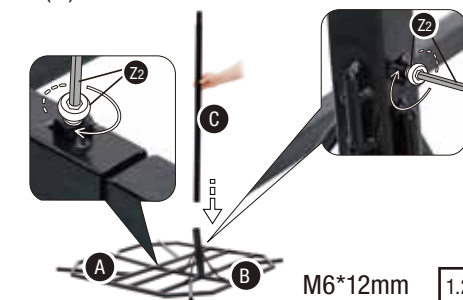

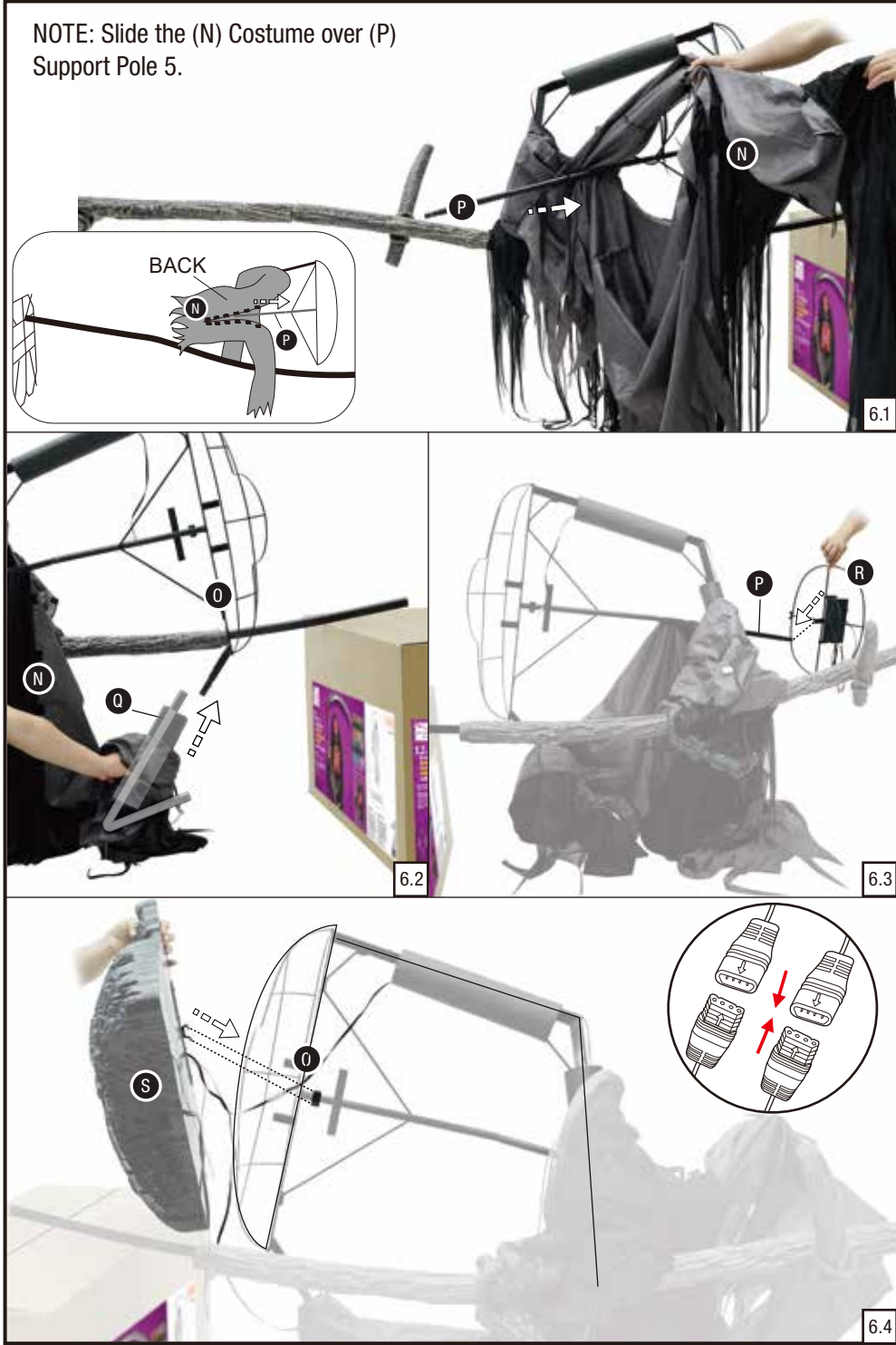
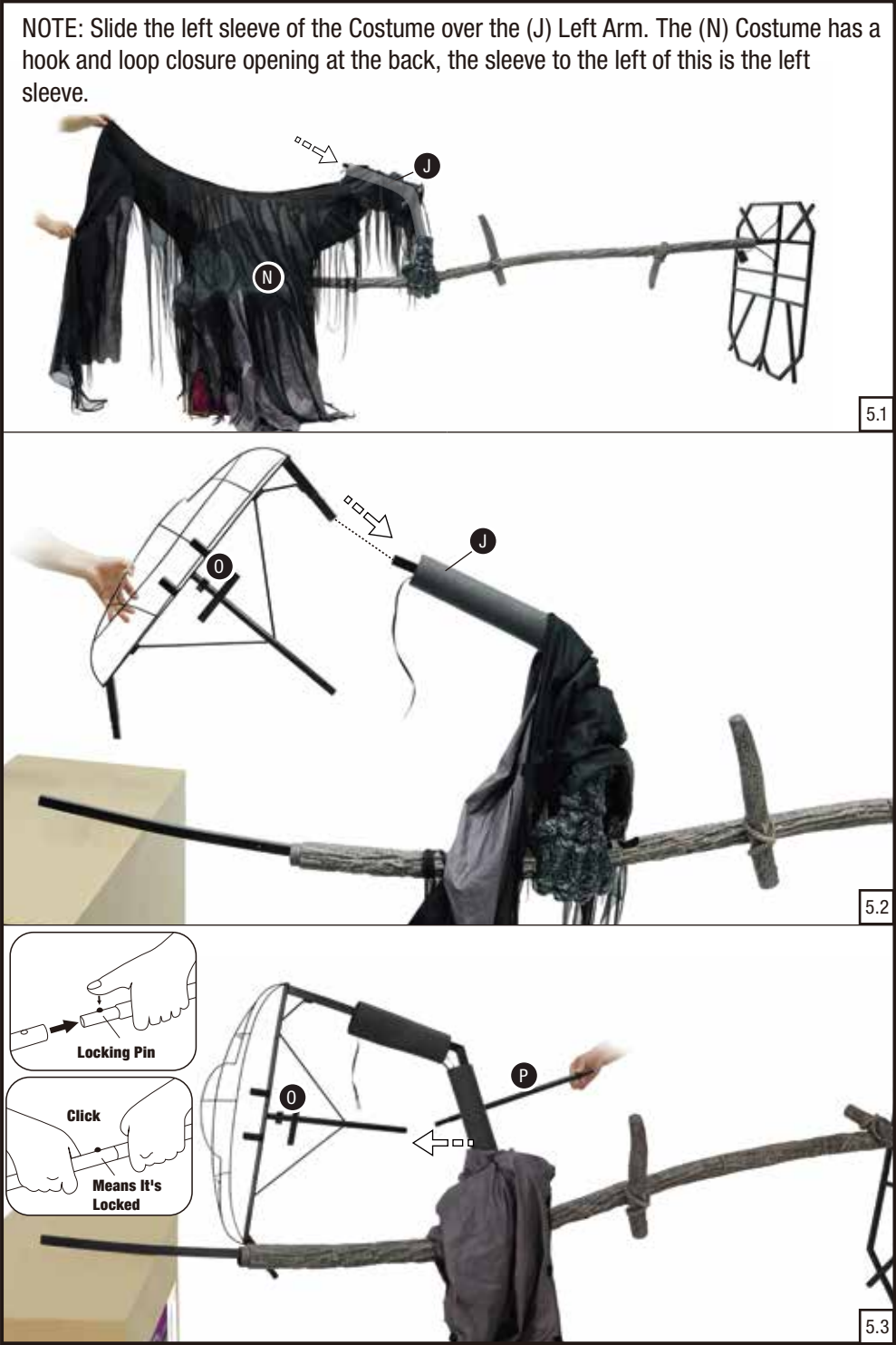
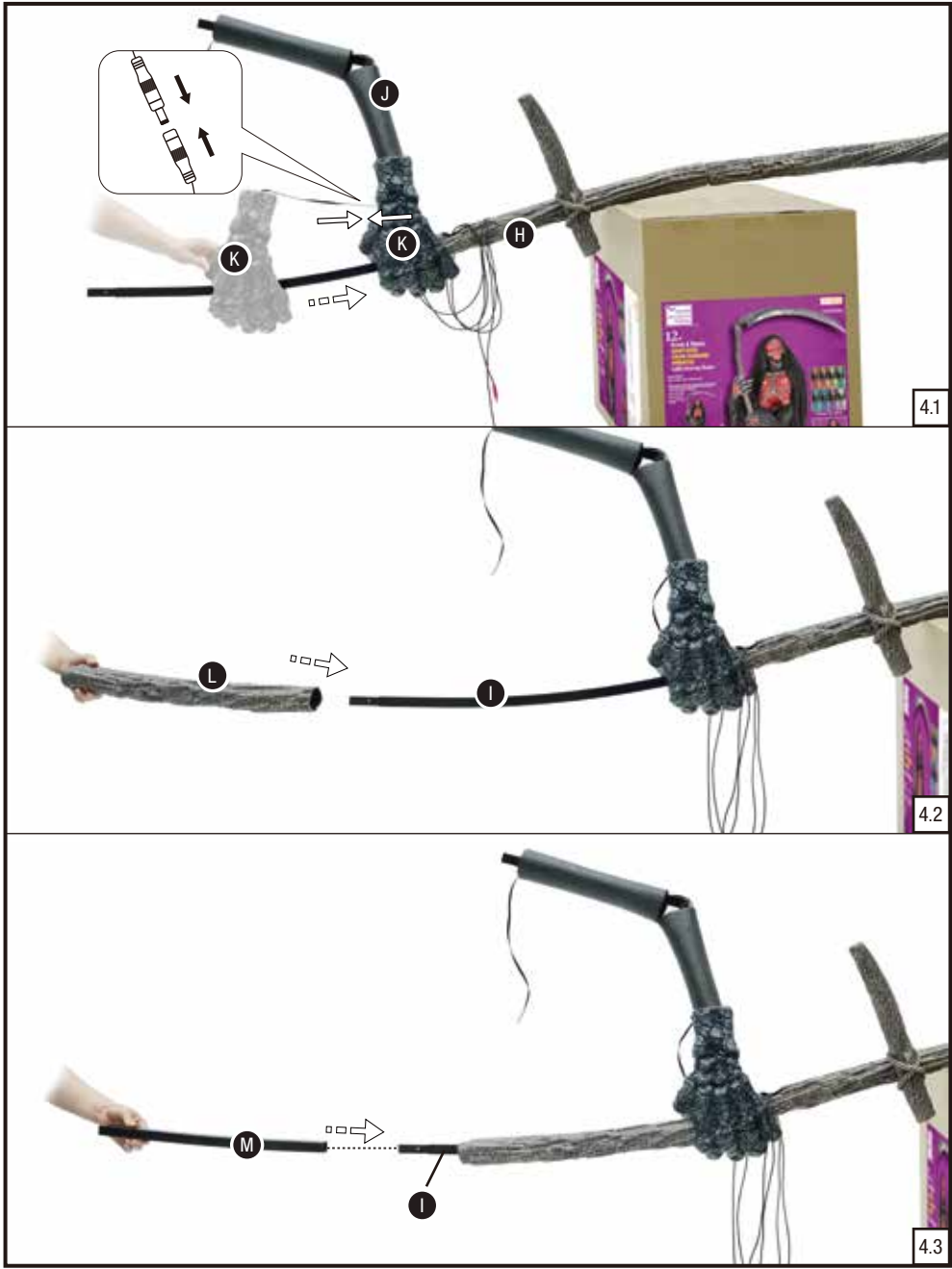
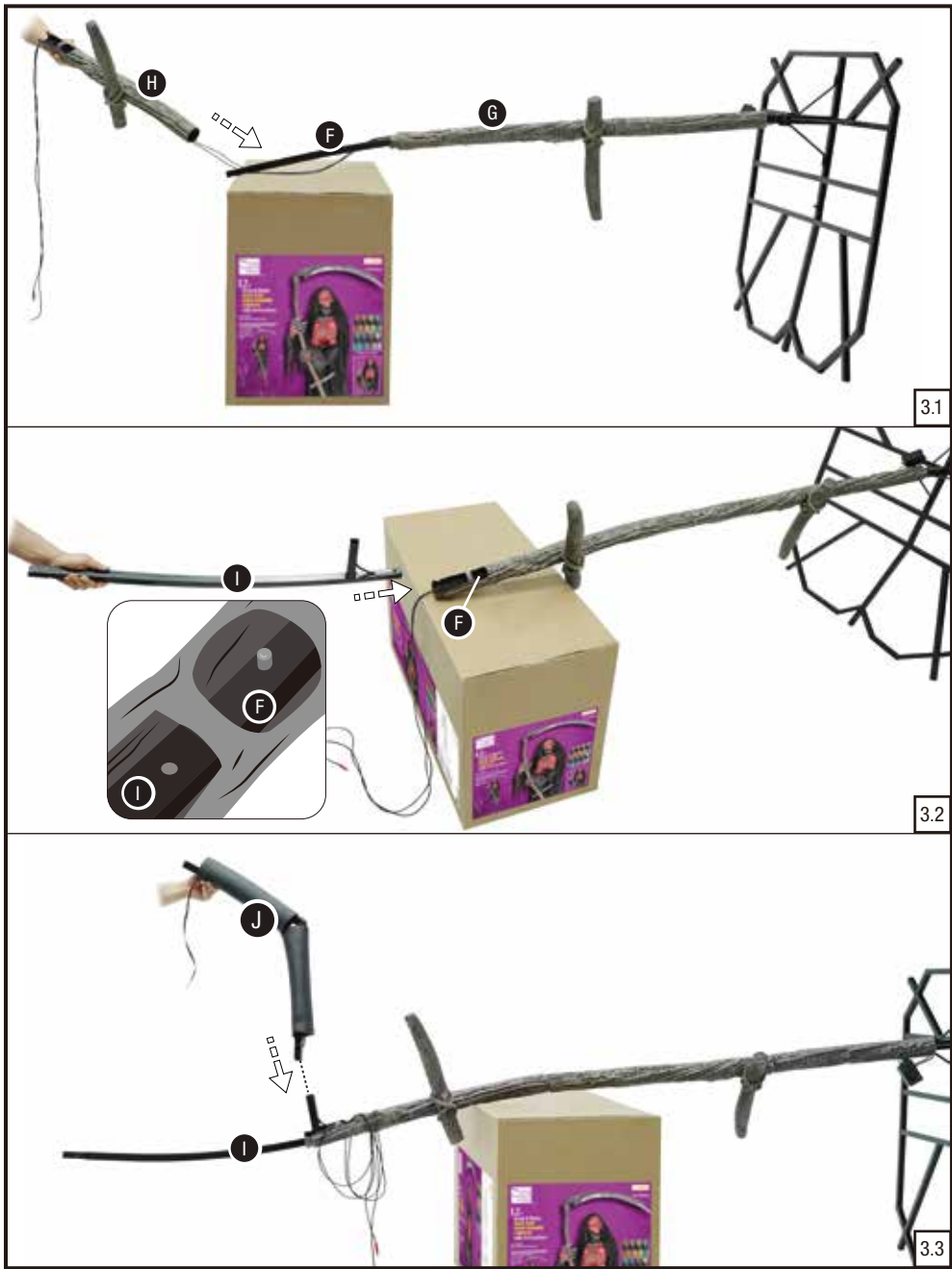

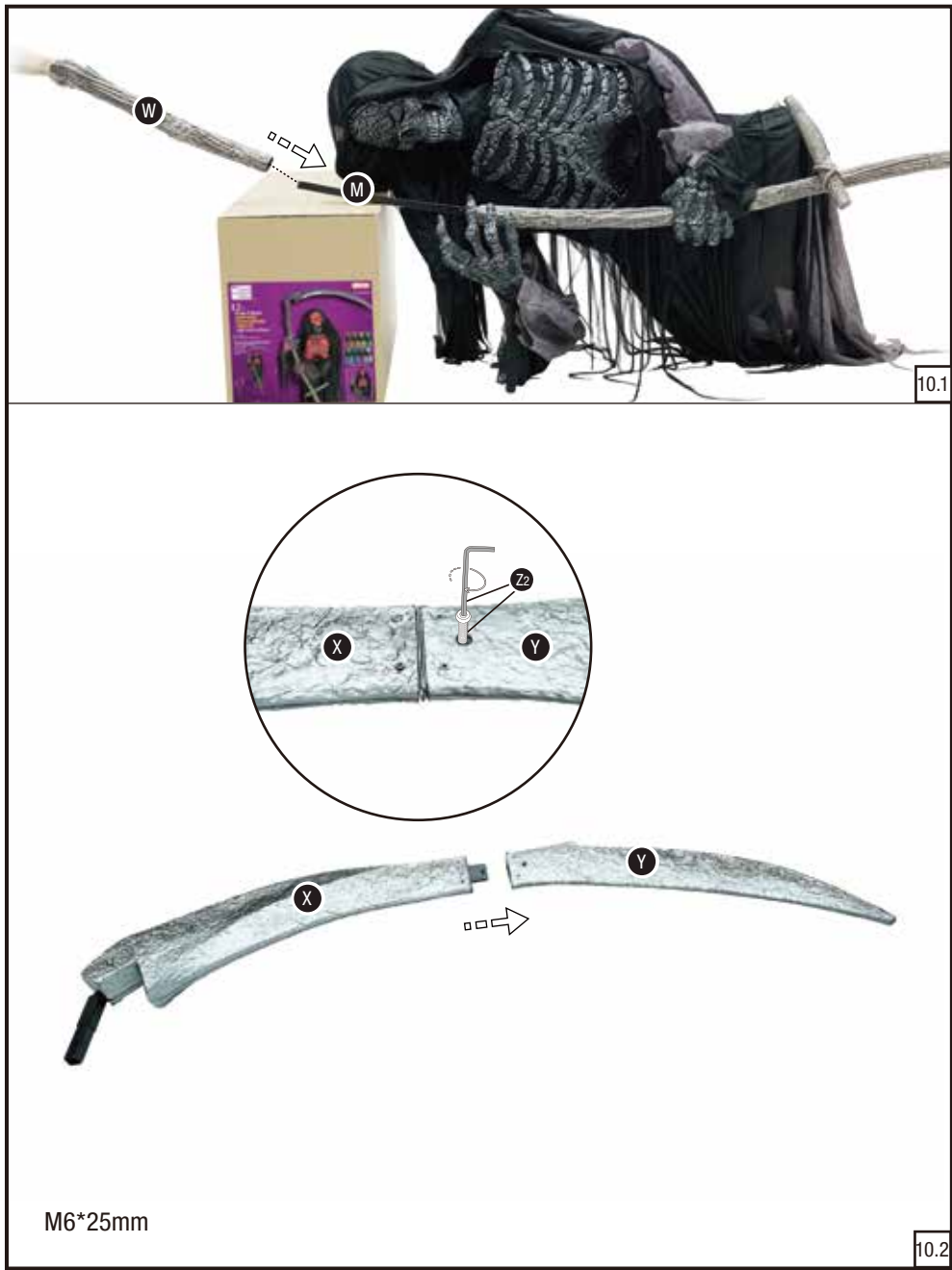
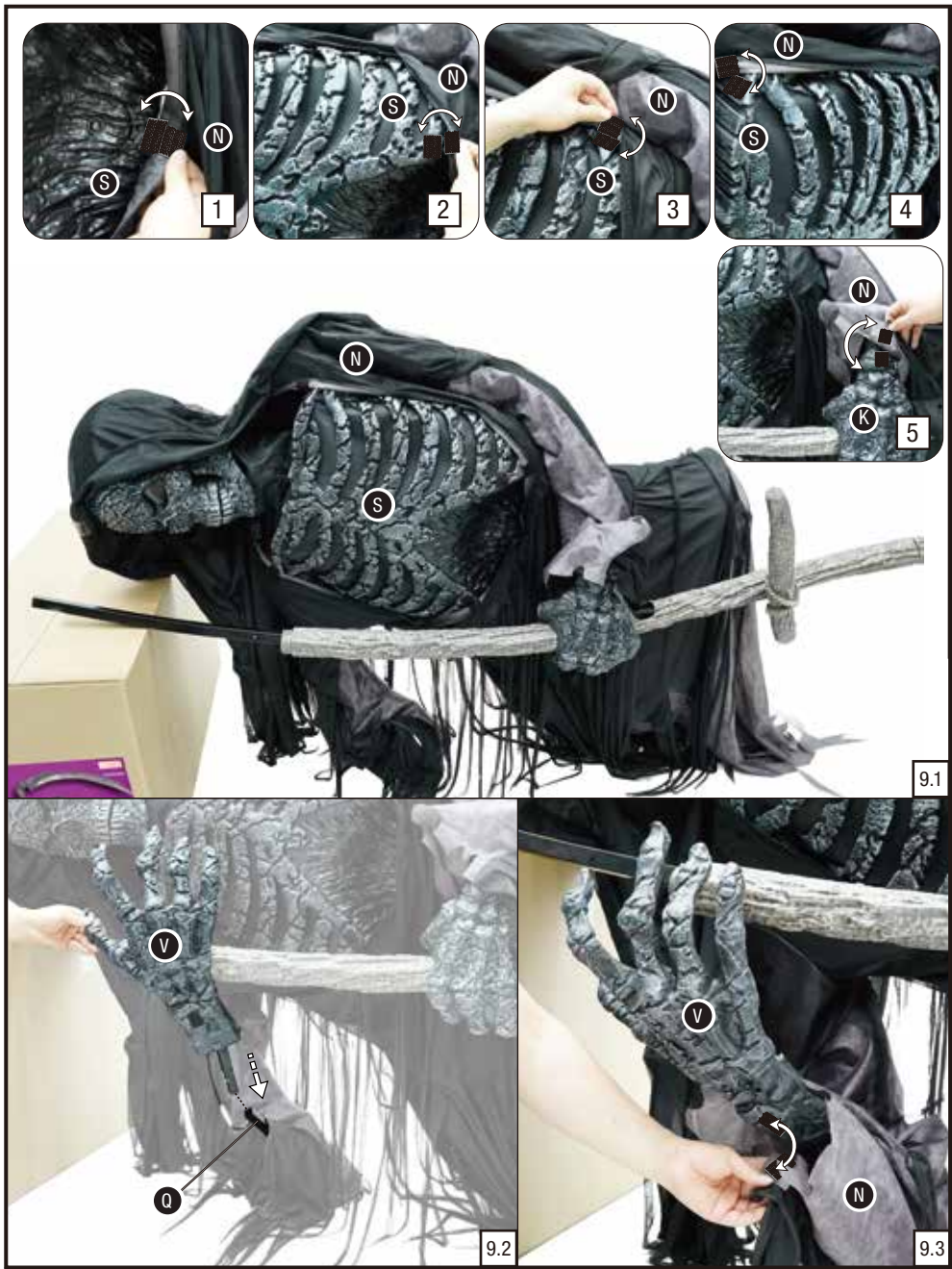
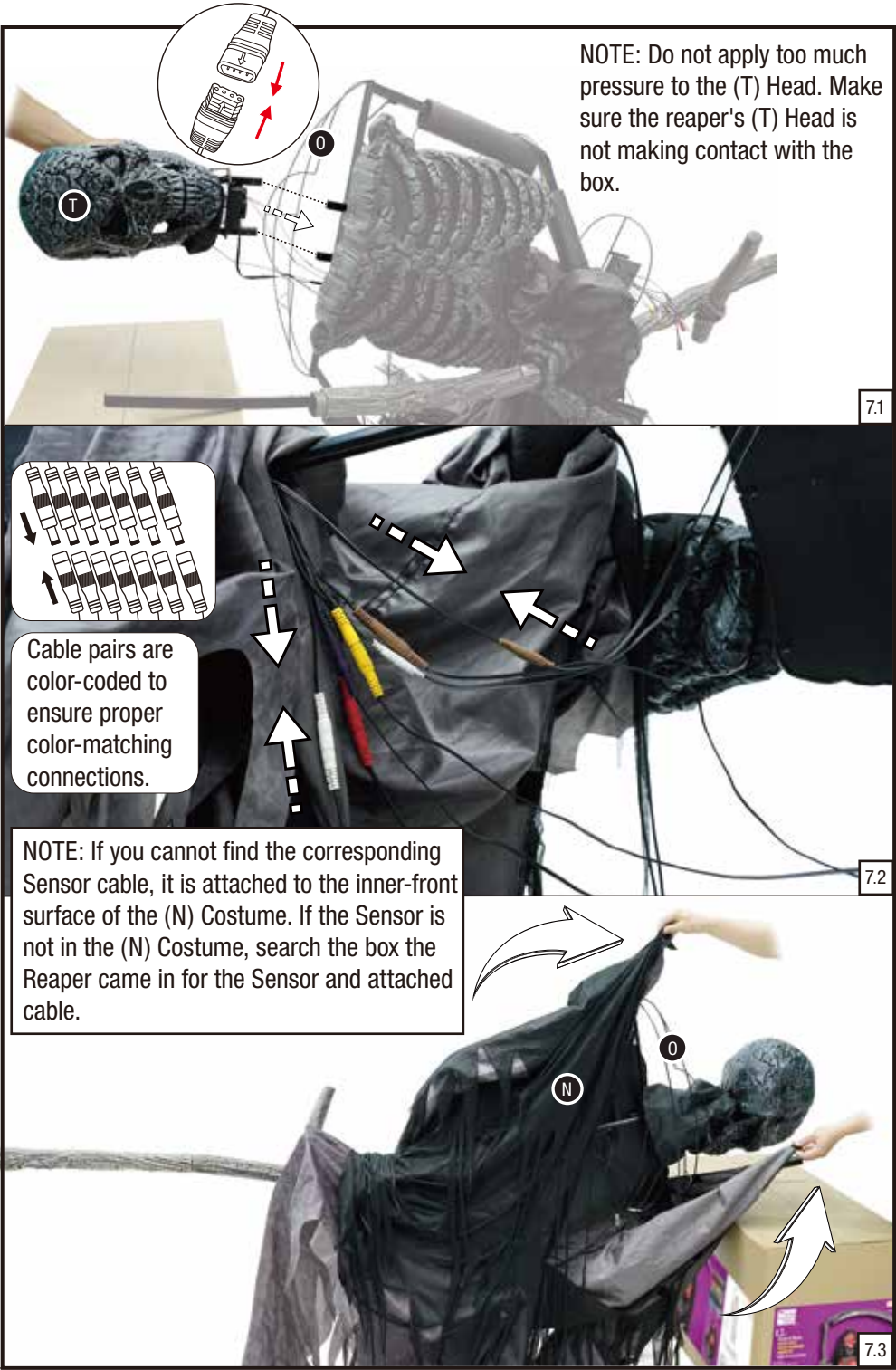

NOTE: Lift up on the assembly when attaching (X) Blade 1 to (M) Support Pole 4.

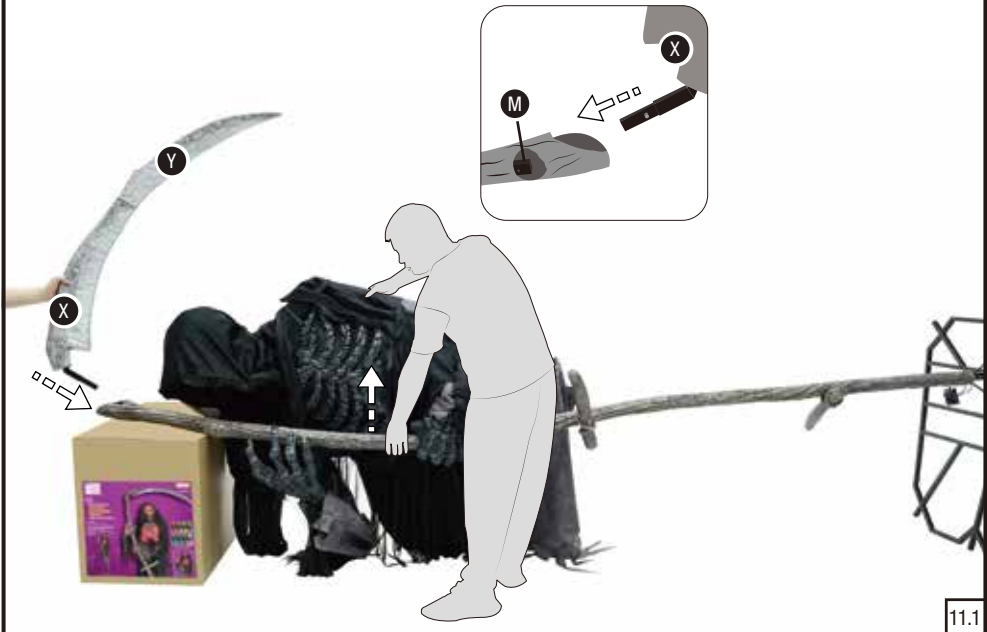

11.1

NOTE: It is strongly recommended that 2-3 adults assist with setting up the 12 ft. Levitating Reaper.



11.2

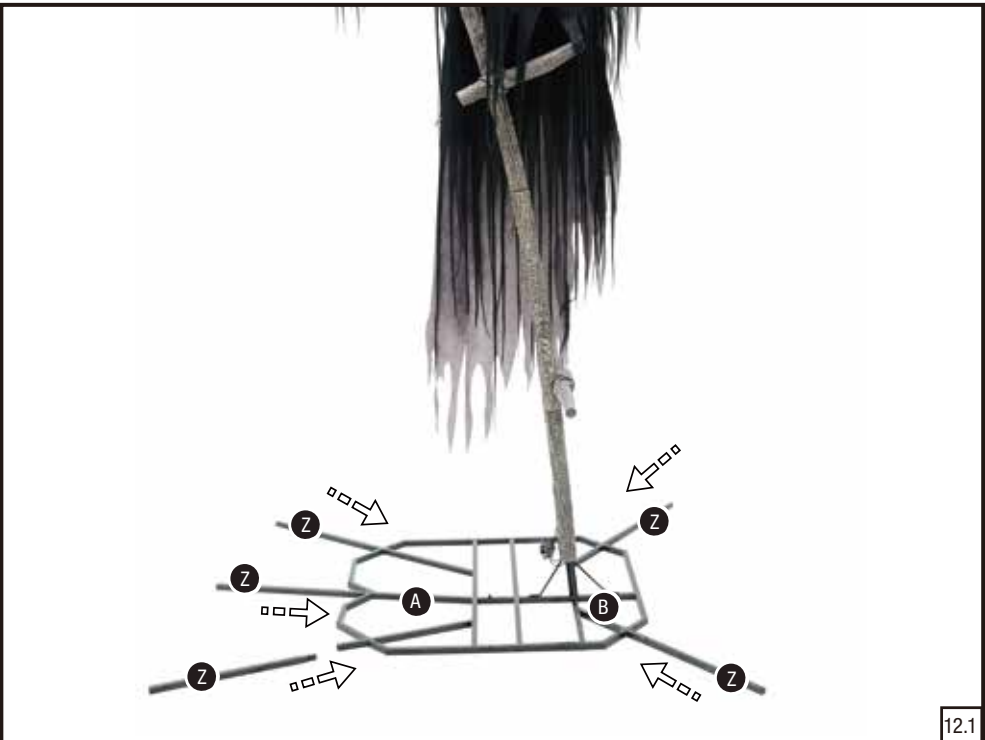

12.1

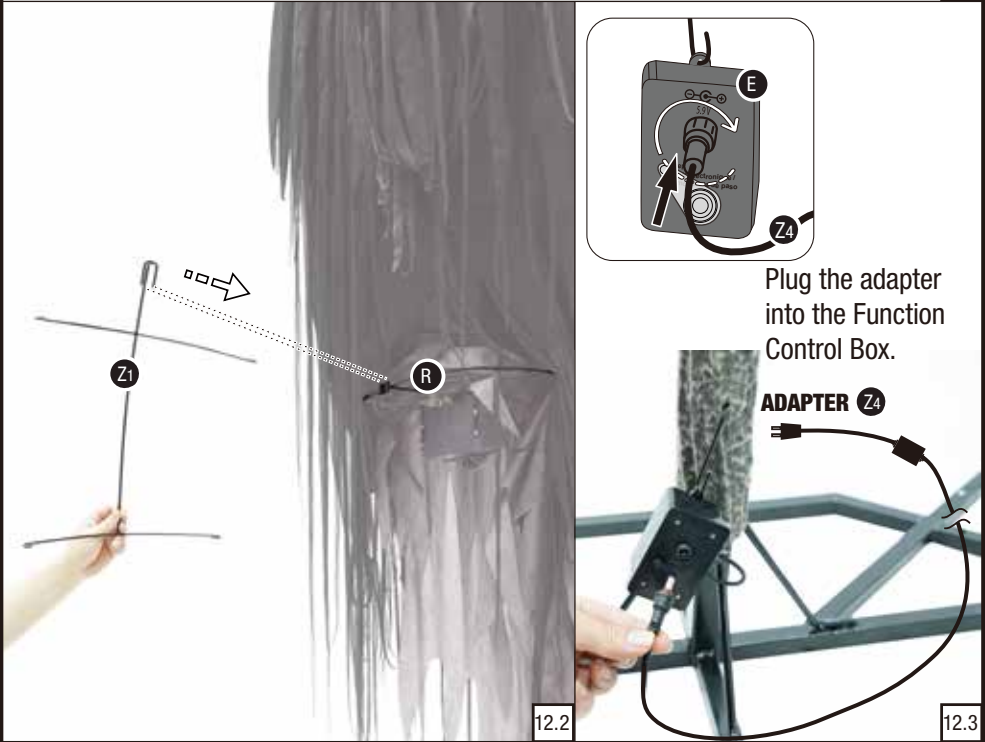

12.3



IR SENSOR
Be sure nothing is blocking the sensor.

YOUR 12 FT. LEVITATING REAPER IS NOW FULLY ASSEMBLED. PLUG IN AND TURN ON TO LET THE FUN BEGIN!

If your application requires additional stability, add weights on top of the base (for example sand bags – not included).

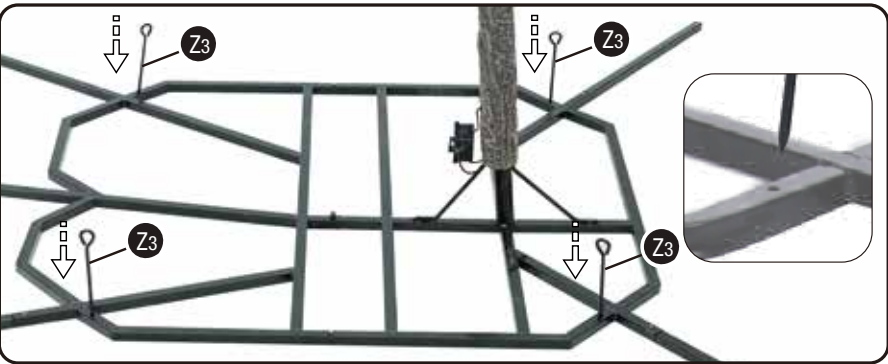
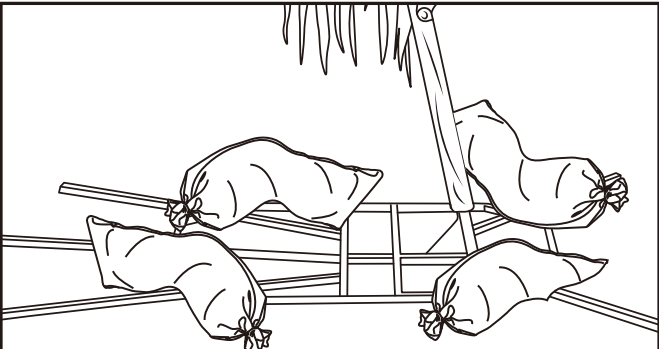

13.1



NOTE: Set to TIMER and SENSOR mode to see the 12 ft. Levitating Reaper speak and move. Between sensor activations, the 12 ft. Levitating Reaper LEDs will remain ON.

In this setting, the lights of the item will activate indefinitely until the setting is changed. This setting mode does not have any animation or sound.

In this setting, the lights will always stay on, but the sound and animation of the item will activate for 1 activity cycle anytime the Infrared (IR) Sensor detects movement. The Infrared (IR) Sensor has a range of up to 4 m/13 ft. and will activate when someone comes within an 80 degree angle from left to right, as well as from above and below.

In this setting, there is an active period of 6 hours and an inactive period of 18 hours. During the 6 active hours, the function will behave like Sensor Mode. The Infrared (IR) Sensor cannot be triggered during the inactive 18 hour period.

This setting will deactivate the lights, sound, and animation of the item. This switch mode allows the item to be activated only if triggered by using a Step Pad or Try Me Button (Not Included). The item will operate for one activity cycle with each Step Pad or Try Me activation.



Light Functions: Red Steady, Yellow Steady, Green Steady, Aqua Steady, Blue Steady, Purple Steady, White Steady and Color Changing

Diagram illustrating the back of the device, showing the battery compartment and the strap attachment point.

The battery compartment is located at the top, featuring a 5.9V battery with positive (+) and negative (-) terminals. The battery is shown inserted into the compartment.

The strap attachment point is located at the bottom, showing a strap with a buckle and a circular hole for the strap to pass through.

Labels in the diagram include:

- 5.9V
- Strap pad /
- Tapis électronique /
- Almohadilla de pas

This item is not a toy and should be used for decoration only. This item contains small parts that can be a choking hazard. Keep all plastic and wire parts away from children.

- Please view all instructions carefully before assembling. Save this instruction sheet for future reference.

- Lay product down before a storm or strong winds.
- Don't climb or pull on product.
- Don't add to or modify product.
- Assemble and place the product on level surfaces only.
- Don't push or tilt product.

When not in use, store this product in its original packing. Keep away from heat and moisture.

This device complies with Part 15 of the FCC Rules. Operation is subject to the following two conditions: (1) This device may not cause harmful interference, and (2) this device must accept any interference received, including interference that may cause undesired operation.

CAUTION: Changes or modifications not expressly approved by the party responsible for compliance could void the user's authority to operate the equipment.

NOTE: This equipment has been tested and found to comply with the limits for a Class B digital device, pursuant to Part 15 of the FCC Rules. These limits are designed to provide reasonable protection against harmful interference in a residential installation. This equipment generates, uses, and can radiate radio frequency energy and, if not installed and used in accordance with the instructions, may cause harmful interference to radio communications. However, there is no guarantee that interference will not occur in a particular installation. If this equipment does cause harmful interference to radio or television reception, which can be determined by turning the equipment off and on, the user is encouraged to try to correct the interference by one or more of the following measures: Reorient or relocate the receiving antenna, Increase the separation between the equipment and receiver. Connect the equipment into an outlet on a circuit different from that to which the receiver is connected. Consult the dealer or experienced radio/TV technician for help.

CAN ICES-003(B)/NMB-003(B)

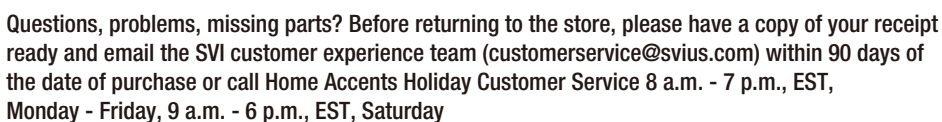

1-855-HD-HOLIDAY (1-855-434-6543)

HOMEDEPOT.COM